



PONTIAC CHASSIS GROUP 5.000



ILLUSTRATION INDEX

TITLE	PAGE
1976-81 DRUM BRAKE & WHEEL CYLINDER/REAR	5-1
1980-81 "X" BRAKE DRUM & WHEEL CYLINDER/REAR	5-2
1976-81 "A,B,F" REAR AXLE ASSEMBLY	5-4
1976-80 "H" REAR AXLE ASSEMBLY	5-6
1976-81 "T" REAR AXLE ASSEMBLY	5-8
1976-80 DIFFERENTIAL/LOCKING (EATON)	5-10
1976-81 DIFFERENTIAL/LOCKING (CORPORATION)	5-11
1976-78 DIFFERENTIAL/LOCKING-7 1/2" (BORG WARNER)	5-12
1977-80 "H" TORQUE ARM SUPPORTS	5-13
1978 HUB CAPS & WHEEL COVERS	5-14
1977-78 HUB CAPS & WHEEL COVERS	5-15
1979 "A" HUB CAPS & WHEEL COVERS	5-16
1979 "A" HUB CAPS & WHEEL COVERS	5-17
1979 "B" HUB CAPS & WHEEL COVERS	5-18
1979 "B" HUB CAPS & WHEEL COVERS	5-19
1979 "F" HUB CAPS & WHEEL COVERS	5-20
1979 "G" HUB CAPS & WHEEL COVERS	5-21
1979 "G" HUB CAPS & WHEEL COVERS	5-22
1979 "H" HUB CAPS & WHEEL COVERS	5-23
1979 "X" HUB CAPS & WHEEL COVERS	5-24
1980-81 "A" HUB CAPS & WHEEL COVERS	5-25
1980-81 "A" HUB CAPS & WHEEL COVERS	5-26
1980-81 "B" HUB CAPS & WHEEL COVERS	5-27
1980-81 "F" HUB CAPS & WHEEL COVERS	5-28
1980 "G" HUB CAPS & WHEEL COVERS	5-29
1980-81 "H" HUB CAPS & WHEEL COVERS	5-30
1980-81 "X" HUB CAPS & WHEEL COVERS	5-31
1981 "T" HUB CAPS & WHEEL COVERS	5-32

GM5-7

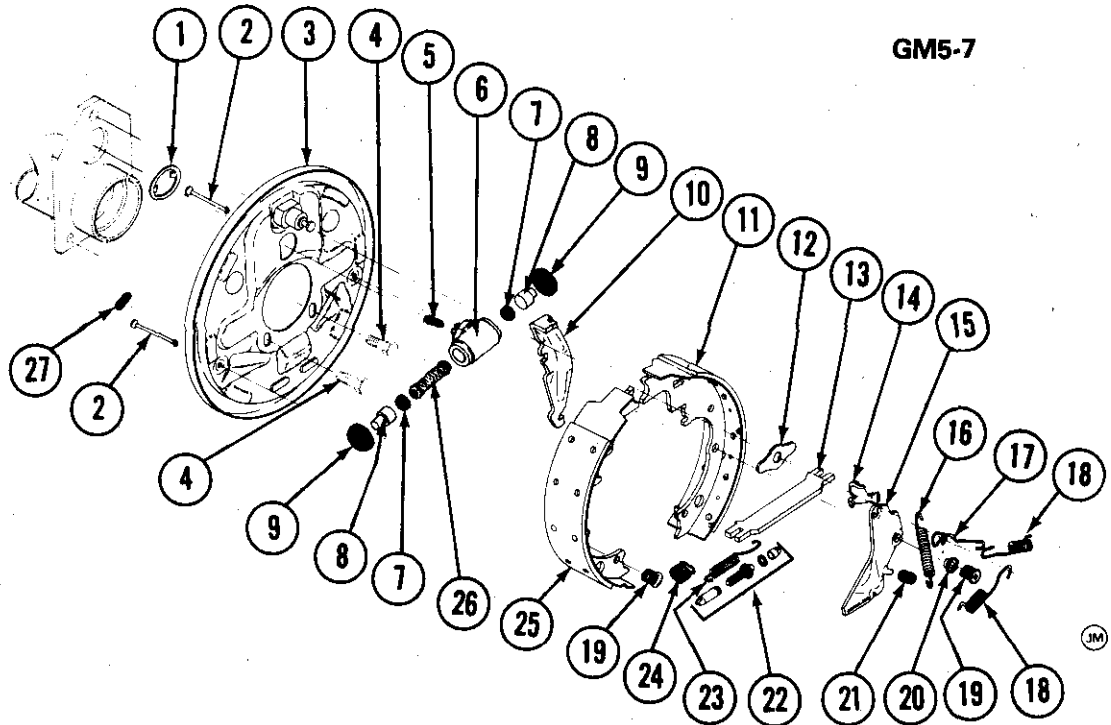

GM5-7

1976-81 DRUM BRAKE & WHEEL CYLINDER/REAR

1.	RETAINER, Whl Cyl(*1,2)	4.665
2.	PIN, Shoe Hold Down(*3)	N.S.
3.	PLATE, Rr Brake Backing	5.001
4.	BOLT, Plate to Axle Housing	5.001
6.	VALVE, Whl Cyl Bleeder(*1)	4.666
6.	HOUSING, Brake Cyl(*1)	N.S.
7.	SEAL, Whl Cyl(*1,2,8)	N.S.
8.	PISTON, Whl Cyl(*1)	N.S.
9.	BOOT, Whl Cyl(*1,2,8)	N.S.
10.	LEVER, Park Brake(*4)	N.S.
11.	SHOE & LINING, Secondary(*5)	N.S.
12.	PLATE, Brake Shoe Guide	5.045
13.	STRUT, Park Brake(*4)	N.S.
14.	PAWL, Brake Adjuster(*6)	N.S.
15.	ACTUATOR, Brake Adjuster(*6)	5.107
16.	SPRING, Actuator Override(*7)	N.S.
17.	LINK, Brake Adjuster(*6)	N.S.
18.	SPRING, Shoe Return(*7)	N.S.
19.	SPRING ASM, Shoe Hold Down(*3)	N.S.
20.	SLEEVE, Adjuster(*3,6)	N.S.
21.	SPRING, Actuator Return(*6,7)	5.107
22.	SCREW KIT, Brake Shoe Adj (Also Incls #27)	5.110
23.	SPRING, Adj Screw(*7)	5.026
24.	SPRING, Park Brake Strut(*4,7)	N.S.
25.	SHOE & LINING, Primary(*5)	N.S.
26.	SPRING ASM, Whl Cyl(*1,2,8)	N.S.
27.	COVER, Brake Adj Hole (Also Part of #22)(*3)	5.117

NOTE 1: Part Of Group 4.665 CYLINDER, Rr Whl Brk
 NOTE 2: Part Of Group 4.667 REPAIR KIT, Whl Cyl - W/Piston
 NOTE 3: Part Of Group 5.043 SPRING KIT, Brk Shoe Holdn
 NOTE 4: Part Of Group 5.149 LEVER & STRUT KIT, Prk Brk
 NOTE 5: Part Of Group 5.017 SHOE KIT, Rr Brk
 NOTE 6: Part Of Group 5.103 LEVER & PAWL KIT, Auto Adj
 NOTE 7: Part Of Group 5.026 SPRING KIT, Brk Shoe Retracting
 NOTE 8: Part Of Group 4.667 REPAIR KIT, Whl Cyl - Less Piston

GM5-8
042082

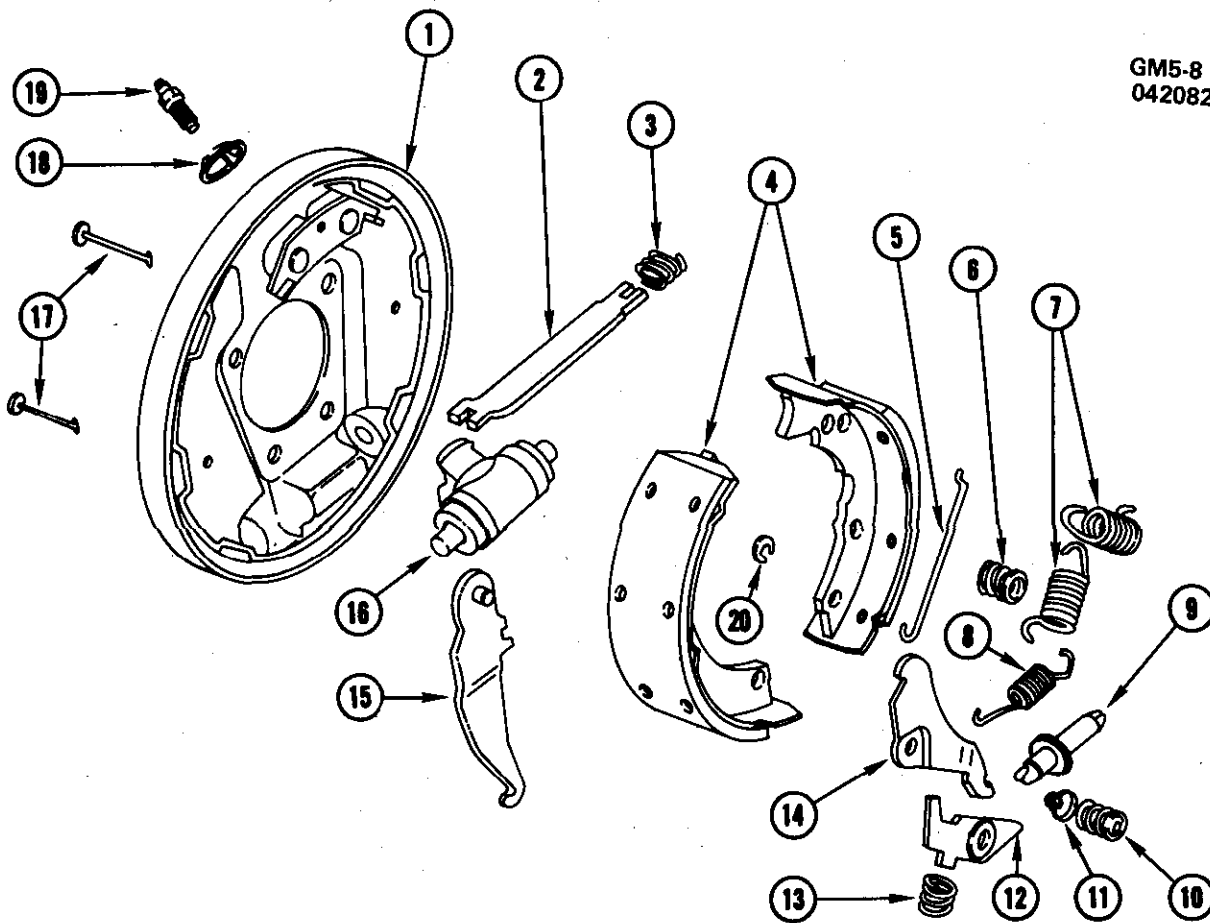

GM5-8

1980-81 "X" BRAKE DRUM & WHEEL CYLINDER/REAR

1.	PLATE, Brake Backing	5.001
2.	STRUT, Parking Brake(*4)	N.S.
3.	SPRING, Parking Brake Strut(*5)	N.S.
4.	SHOE KIT, Rear Brake	5.017
5.	LINK, Brake Adjuster(*1)	N.S.
6.	SPRING, Shoe Hold Down(*3)	N.S.
7.	SPRING, Return(*2)	N.S.
8.	SPRING, Adjuster Screw(*2)	N.S.
9.	SCREW KIT, Automatic Adjuster	5.110
10.	SPRING, Shoe Hold Down(*3)	N.S.
11.	SLEEVE, Adjuster(*1,3)	N.S.
12.	PAWL, Brake Adjuster(*1)	N.S.
13.	SPRING, Actuator Return(*1,2)	N.S.
14.	ACTUATOR, Brake Adjuster(*1)	N.S.
15.	LEVER, Parking Brake(*4)	5.149
16.	CYLINDER, Rear Wheel	4.665
	REPAIR KIT, Rear Wheel Cylinder	4.667
17.	PIN, Shoe Hold Down(*3)	N.S.
18.	RETAINER, Rear Wheel Cylinder	4.665
19.	VALVE KIT, Wheel Cylinder Bleeder	4.666
20.	RING, Parking Brake Lever (5/16")(*4)	8.934

NOTE 1: 5.103 REPAIR KIT, Rear Brake Automatic Adjuster

NOTE 2: 5.151 SPRING KIT, Rear Brake

NOTE 3: 5.043 SPRING KIT, Rear Brake Hold Down

NOTE 4: 5.149 LEVER, W/Strut Rear Parking Brake

NOTE 5: 5.151 18012429-SPRING KIT, Park Brk Strut.

NOTES

BLANK-22

GM5-4

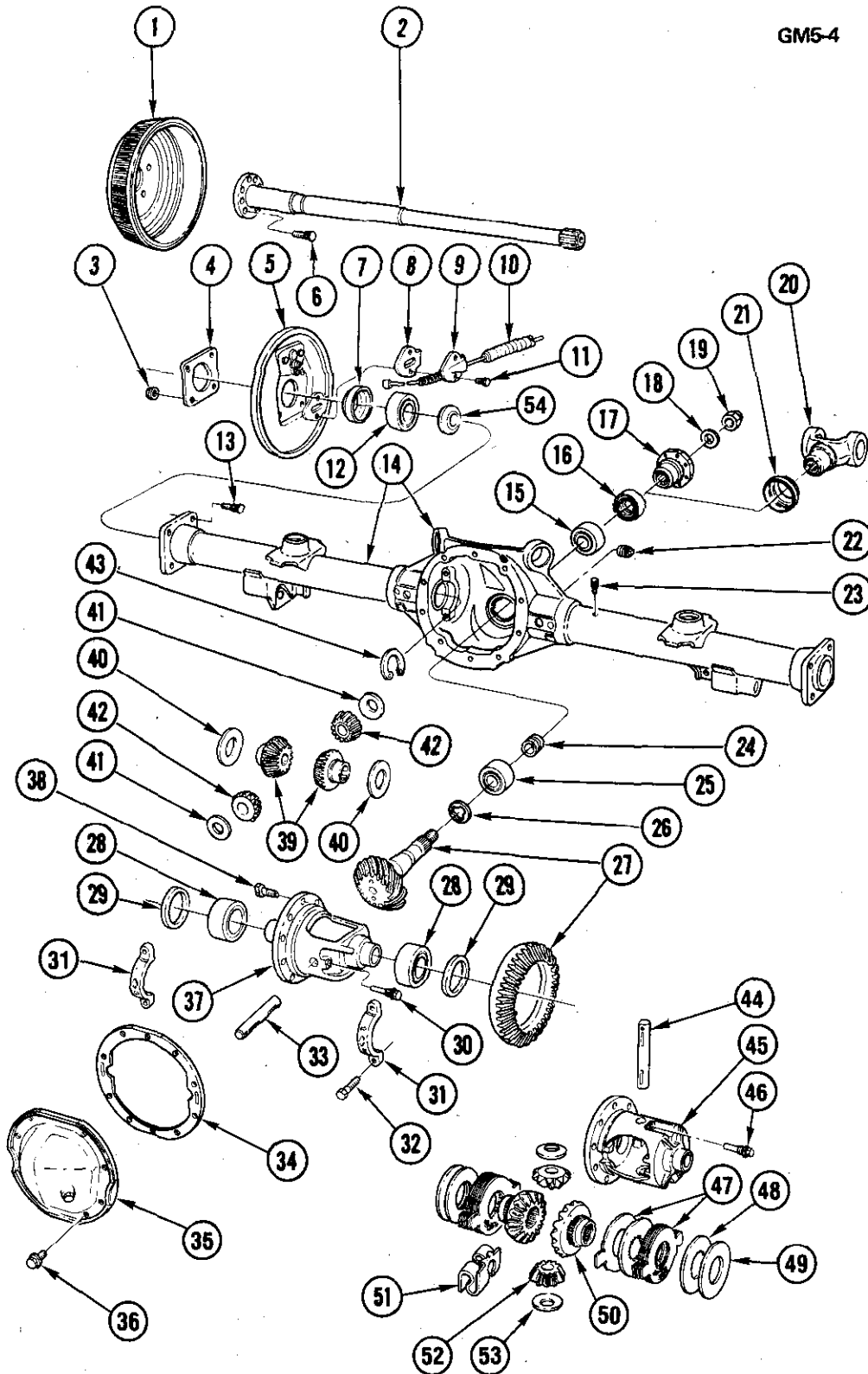

LIMITED SLIP DIFFERENTIAL (G80)

GM5-4

1976-81 "A,B,F" REAR AXLE ASSEMBLY

1976-81 "A,B,F" REAR AXLE ASSEMBLY

1.	DRUM ASM, Rear Brake	5.809
2.	SHAFT, Rear Axle	5.420
3.	NUT, Brake Backing Plate to Axle Housing	5.002
4.	RETAINER, Rear Axle Shaft Bearing-Outer	5.816
5.	PLATE, Rear Brake Backing	5.001
6.	BOLT, Rear Wheel Hub	5.812
7.	SEAL, Rear Wheel Bearing	5.822
8.	FELT, Parking Brake Cable Anchor to Bracket	4.784
9.	ANCHOR, Parking Brake Cable to Rear Brake	4.785
10.	CABLE, Parking Brake-Rear	4.779
11.	BOLT, Hex	8.900
12.	BEARING ASM, Rear Axle Shaft	5.855
13.	BOLT, Backing Plate to Axle Housing	5.002
14.	HOUSING ASM, Rear Axle	5.387
15.	BEARING ASM, Rear Axle Drive Pinion-Front	5.447
16.	SEAL, Rear Axle Drive Pinion Flange Oil	5.469
17.	FLANGE, Prop Shaft Pinion	5.545
18.	WASHER, Prop Shaft Pinion Flange	5.595
19.	NUT, Prop Shaft Pinion Flange	5.595
20.	FLANGE, Prop Shaft Pinion	5.545
21.	DEFLECTOR, Prop Shaft Pinion Flange	5.545
22.	PLUG, Rear Axle Filler (Was 5.400)	8.971
23.	VENTILATOR, Diff Carrier	5.387
24.	SPACER, Drive Pinion-Frt	5.453
25.	BEARING ASM, Drive Pinion-Rear	5.484
26.	SHIM KIT, Pinion Shaft Brg-Selective	5.460
27.	GEAR KIT, Ring and Pinion	5.529
28.	BEARING ASM, Diff Side	5.536
29.	SHIM KIT, Diff Bearing Adj-Selective	5.537
30.	SCREW, Pinion Shaft Lock	5.518
31.	CAP, Side Bearing (Part of Carrier Asm)	N.S.
32.	BOLT, Side Bearing Cap	5.506
33.	SHAFT, Differential Pinion	5.517
34.	GASKET, Axle Housing Cover	5.399
35.	COVER, Axle Housing	5.398
36.	BOLT, Axle Housing Cover	5.398
37.	CASE, Differential	5.510
38.	BOLT, Ring Gear to Case	5.531
39.	GEAR, Differential Side	5.528
40.	WASHER, Diff Side Gear Thrust	5.543
41.	WASHER, Diff Pinion Thrust	5.542
42.	GEAR, Differential Pinion	5.526
43.	LOCK, Axle Shaft	5.422
44.	SHAFT, Differential Pinion	5.517
45.	CASE, Differential (Includes Gears)	5.510
46.	SCREW, Pinion Shaft Lock	5.518
47.	CLUTCH KIT, Diff Friction Disc	5.511
48.	SPACER, Differential Friction	5.511
49.	SHIM, Differential Clutch	5.511
50.	GEAR, Differential Side	5.528
51.	SPRING, Differential Preload	5.511
52.	GEAR, Differential Pinion	5.528
53.	WASHER, Differential Pinion Thrust	5.542
54.	RETAINER, Brg Inner	5.816

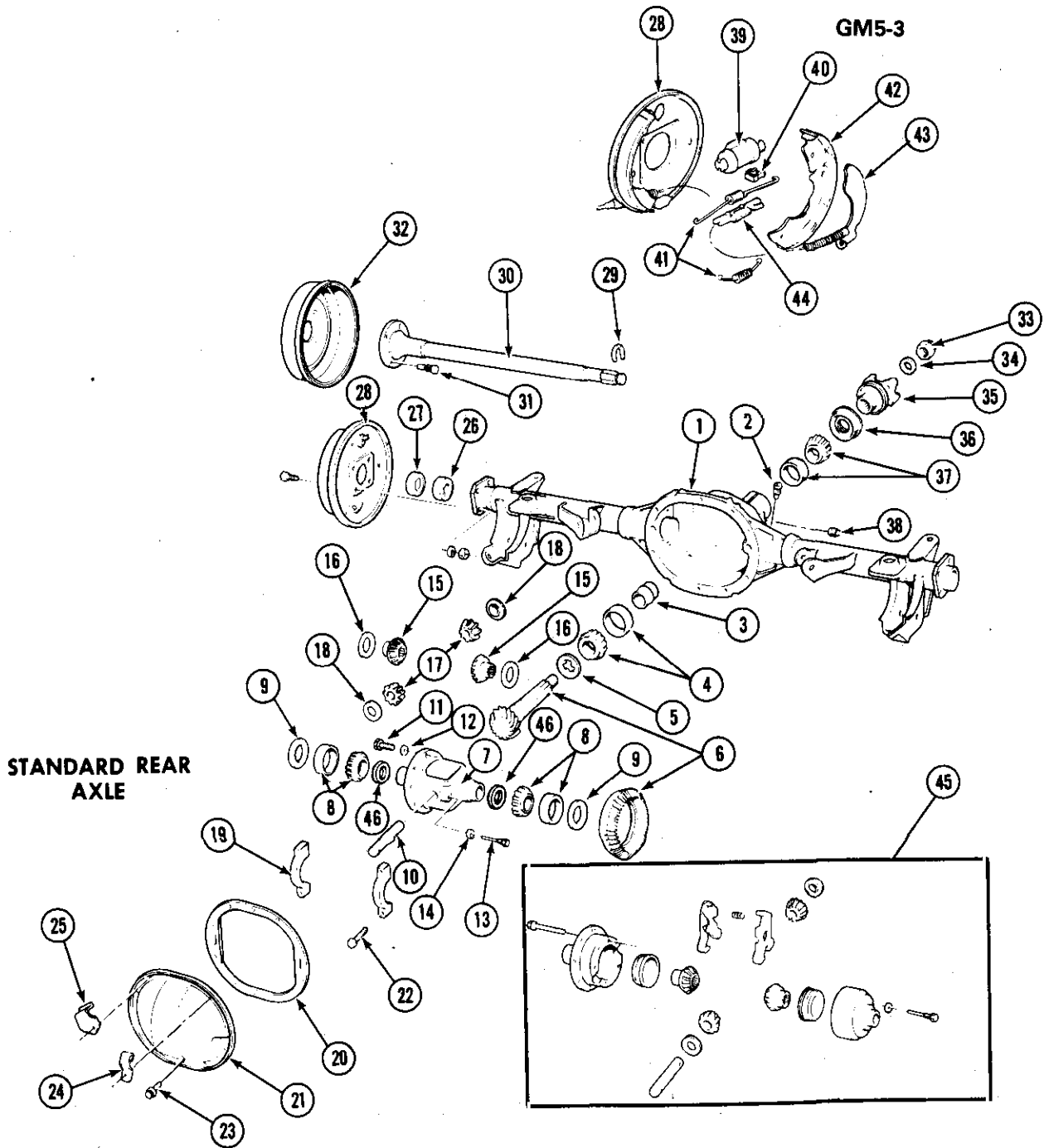

1976-80 "H" REAR AXLE ASSEMBLY

GM5-3

1976-80 "H" REAR AXLE ASSEMBLY

1.	HOUSING, Rear Axle (With Spacer)	5.387
2.	VENTILATOR ASM, Rear Axle Housing	5.387
3.	SPACER, Pinion Shaft Bearing	5.453
4.	BEARING ASM, Drive Pinion Gear	5.484
5.	SHIM KIT, Pinion Shaft Bearing	5.460
6.	GEAR KIT, Ring & Pinion	5.529
7.	CASE, Differential-Less Internal Gears	5.510
8.	BEARING ASM, Differential Side	5.536
9.	SHIM KIT, Side Bearing Adjusting	5.537
10.	SHAFT, Differential Pinion	5.517
11.	BOLT, Drive Gear	5.531
12.	WASHER, Lock Drive Gear Bolt (3/8")	8.931
13.	SCREW, Pinion Shaft Lock	5.518
14.	WASHER, Lock Shaft Lock Screw (1/4")	8.931
15.	GEAR, Differential Side	5.528
16.	WASHER, Side Gear Thrust	5.543
17.	GEAR, Differential Pinion	5.526
18.	WASHER, Pinion Thrust	5.542
19.	CAP, Carrier Bearing (Part of #1)	N.S.
20.	GASKET, Axle Housing Cover	5.399
21.	COVER, Axle Housing	5.398
22.	BOLT, Carrier Bearing Cap	5.506
23.	BOLT, Hex Cover to Case (5/16"-18 x 11/16")	8.900
24.	CLIP, Rear Brake Rear Pipe	4.686
25.	BRACKET, Rear Brake Hose Axle	4.681
26.	BEARING ASM, Rear Wheel	5.855
27.	SEAL, Rear Wheel Bearing	5.822
28.	PLATE, Rear Brake Backing	5.001
29.	LOCK, Axle Shaft	5.422
30.	SHAFT, Axle	5.420
31.	BOLT, Rear Wheel Hub	5.812
32.	DRUM ASM, Rear Wheel Brake	5.809
33.	NUT, Pinion Flange (7/8"-16)	5.595
34.	WASHER, Pinion Flange Retaining	5.595
35.	FLANGE, Prop Shaft Pinion	5.545
36.	SEAL ASM, Drive Pinion	5.469
37.	BEARING ASM, Drive Pinion-Front	5.447
38.	PLUG, Axle Filler	5.400
39.	CYLINDER ASM, Rear Wheel Brake	4.665
40.	SPRING KIT, Brake Shoe Hold Down	5.043
41.	SPRING, Rear Brake Shoe Pull Back	5.026
42.	SHOE KIT, Rear Brake	5.017
43.	LEVER, Parking Brake Shoe	5.149
44.	STRUT ASM, Parking Brake Shoe Lever	5.150
45.	CASE, Differential (W/Internal Gears-G80)	5.510
46.	SPACER, Side Bearing	5.537

GM05-011
082383

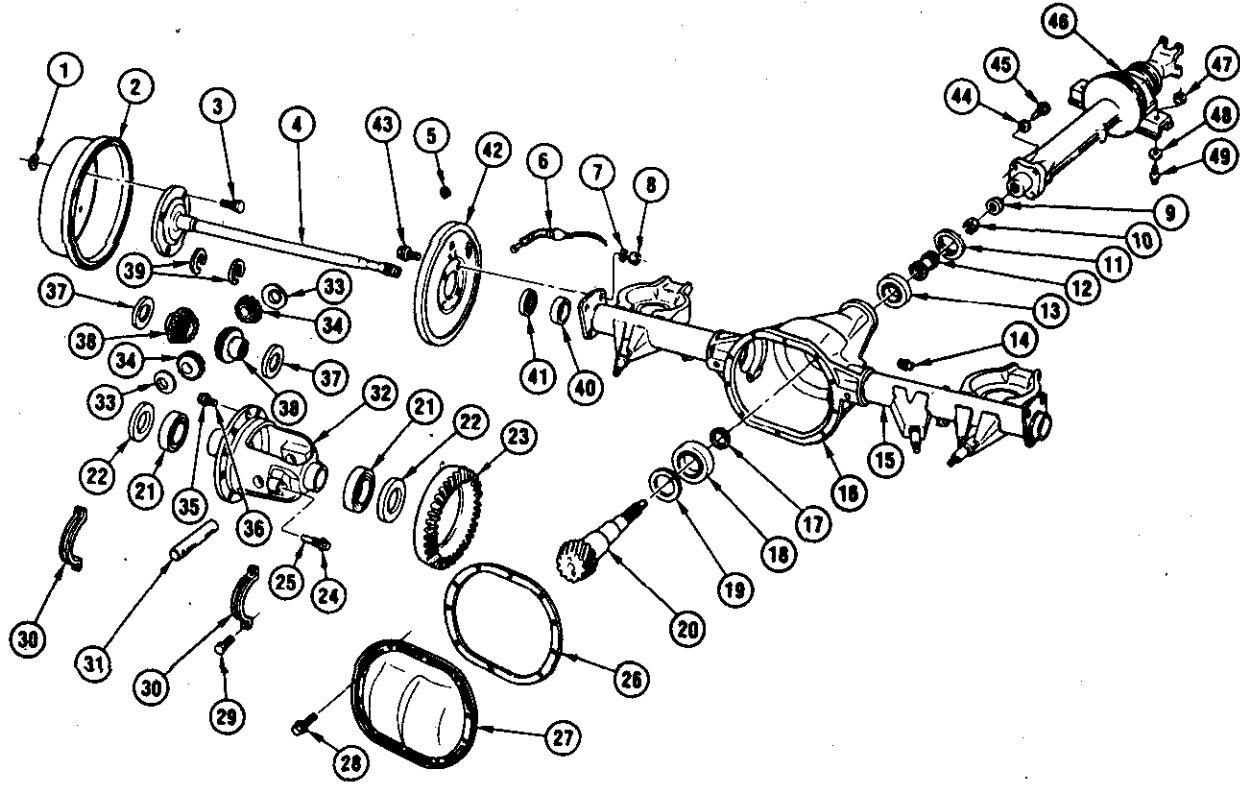

GM05-011

1976-81 "T" REAR AXLE ASSEMBLY

GM05-011

1976-81 "T" REAR AXLE ASSEMBLY

1. NUT, Push Rear Brk Drum	5.813	26. GASKET, Diff Carrier	5.399
2. DRUM ASM, Rear	5.809	27. COVER, Diff Carrier	5.398
3. BOLT, Rear	5.812	28. SCREW, Oil Pump Suction Pipe & Screen Supt	5.398
4. SHAFT ASM, Rear Axle	5.420	29. BOLT, Diff Carrier	5.506
5. RING, Retaining	8.934	30. CAP, Carrier Bearing (Part of #17)	N.S.
6. CABLE ASM, Prk Brk Rr	4.779	31. SHAFT, Diff Pinion	5.517
7. WASHER, Flat (M8)	8.929	32. CASE, Diff	5.510
8. NUT, Hex (M8 x 1.25)	8.915	33. WASHER, Diff Pinion Thrust	5.542
9. CAP, Pinion Ext Thrust	5.533	34. GEAR, Diff Pinion	5.528
10. NUT, Drive Pinion	5.595	35. WASHER, Lock (3/8")	8.931
11. SEAL ASM, Dr Png Oil	5.469	36. BOLT, Hypoid Drive Gear	5.531
12. SLEEVE, Drive Pinion	5.440	37. WASHER, Diff Side Gear Thrust	5.543
13. BEARING ASM, Drive Pinion	5.447	38. GEAR, Diff Side	5.528
14. PLUG, Sq Socket Drain (1/2"-14)	8.971	39. LOCK, Axle Shaft	5.422
15. HOUSING, Rear Axle	5.387	40. BEARING ASM, Rear Whl	5.855
16. HOUSING, Diff (Part of #15)	N.S.	41. SEAL ASM, Rear Whl Bearing	5.822
17. SPACER, Pinion Bearing	5.453	42. PLATE ASM, Brake Flange	5.001
18. BEARING ASM, Drive Pinion Gear	5.484	43. BOLT, Hex (M8 x 1.25 x 20)	8.900
19. SHIM KIT, Pinion Shaft Bearing	5.460	44. WASHER, (M12 X 1.75)	8.929
20. GEAR KIT, Ring & Pinion	5.529	45. BOLT, (M12 X 1.75 X35)	8.900
21. BEARING, Diff Side	5.536	46. EXTENSION, Rr Axle	5.450
22. SHIM KIT, Side Bearing Adj	5.537	47. WASHER, Flt (.453)	8.929
23. GEAR KIT, Ring & Pinion	5.529	48. WASHER (.120 X.440 X .870)	8.929
24. WASHER, Lock Shaft Lock (1/4")	8.931	49. BOLT, Rr Axle Ext To Body (4.085)	5.387
25. SCREW, Pinion Shaft Lock	5.518		

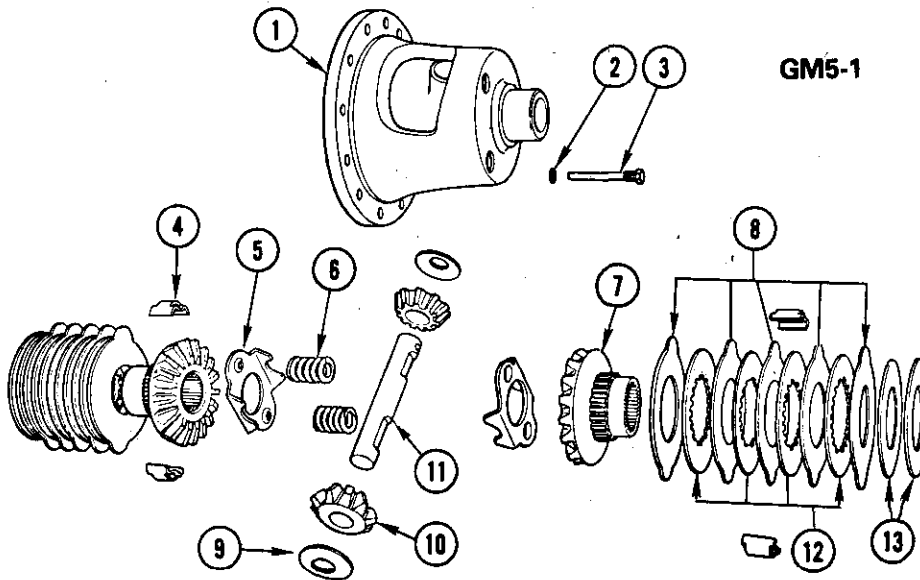

GM5-1

1976-80 DIFFERENTIAL/LOCKING (EATON)

1.	CASE, Differential	5.510
2.	WASHER, Lock, Pinion Pin Lock Screw	8.931
3.	SCREW, Pinion Pin Lock	5.518
4.	GUIDE, Differential Disc(* 1)	5.511
5.	PLATE, Differential Pre-Load	5.511
6.	SPRING, Differential Pre-Load	5.511
7.	GEAR, Differential Side	5.528
8.	DISC, Friction-Eared(* 1)	N.S.
9.	WASHER, Differential Pinion Thrust	5.542
10.	GEAR, Differential Pinion	5.528
11.	SHAFT, Differential Pinion	5.517
12.	DISC, Friction-Splined(* 1)	N.S.
13.	SHIM, Clutch Disc	5.511

NOTE 1: Part of DISC REPAIR PKG-5.511.

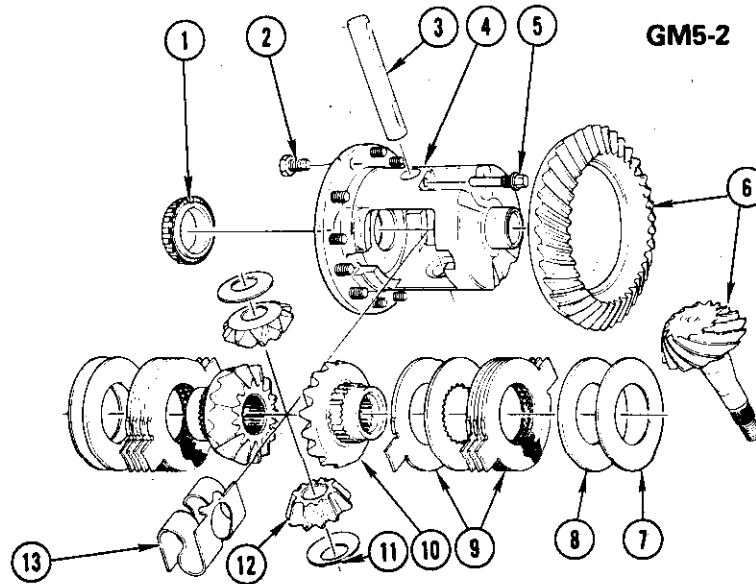

GM5-2

1976-81 DIFFERENTIAL/LOCKING (CORPORATION)

1.	BEARING ASM, Differential Side	5.536
2.	BOLT, Ring Gear to Case	5.531
3.	SHAFT, Pinion	5.517
4.	CASE, Differential (Less Gears)	5.510
5.	SCREW, Pinion Shaft Lock	5.518
6.	GEAR KIT, Ring & Pinion	5.529
7.	SHIM, Clutch	5.511
8.	SPACER, Clutch	5.511
9.	CLUTCH KIT, W/Disc	5.511
10.	GEAR, Differential Side	5.528
11.	WASHER, Side Pinion	5.542
12.	GEAR, Pinion	5.526
13.	SPRING, Preload	5.511

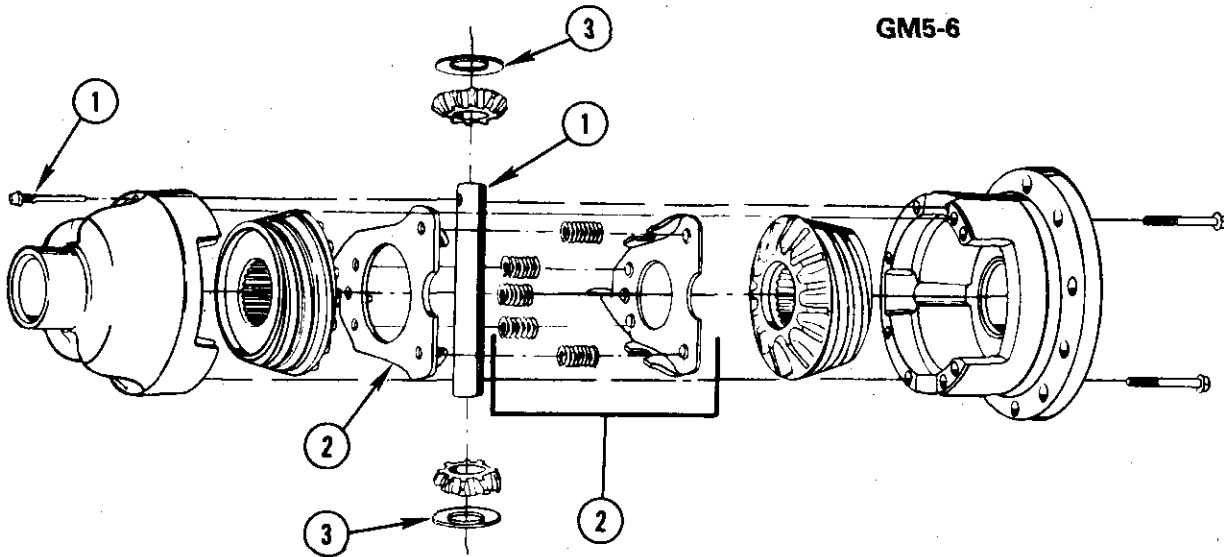

GM5-6

GM5-6

1976-78 DIFFERENTIAL/LOCKING-7 1/2" (BORG WARNER)

- | | | |
|----|--|-------|
| 1. | SHAFT KIT, Diff Pinion | 5.517 |
| 2. | SPRING, W/Retainer Diff Pre-Load | 5.511 |
| 3. | WASHER KIT, Diff Pinion Thrust | 5.542 |

Note: If Case, Clutch Cones Or Sides Gears Are Damaged, It Is Necessary To Replace The Case Assembly-Group 5.510.

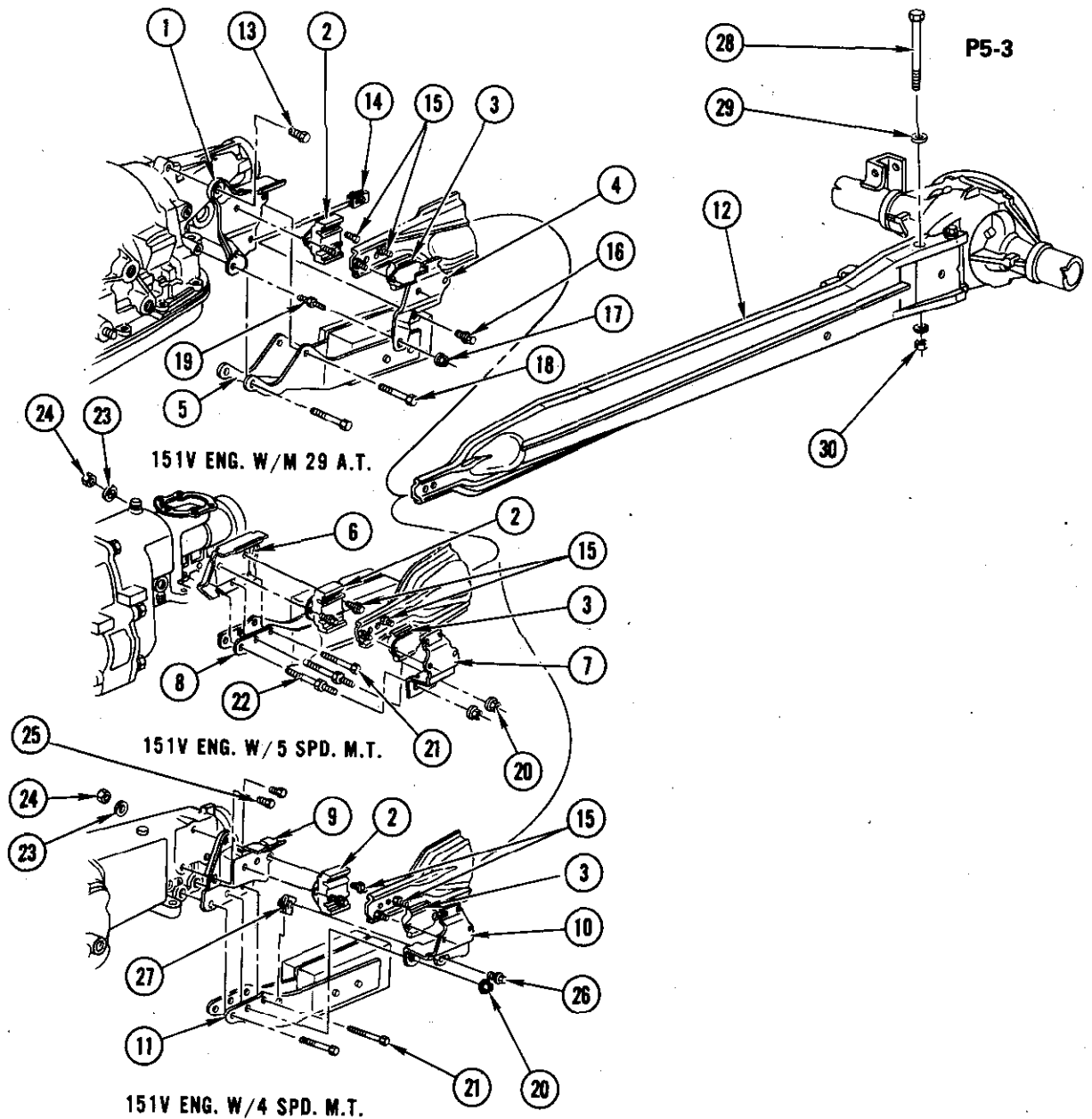

1977-80 "H" TORQUE ARM SUPPORTS

1. SUPPORT, Arm to Trans Inr (M29)	5.380	17. NUT, Hex (M8 x 1.25)	8.915
2. INSULATOR, Arm to Supt Inr	5.380	18. BOLT (3/8" x 16 x 3 1/2")	8.900
3. INSULATOR, Arm to Supt Otr	5.380	19. STUD, Arm Inr to Otr Supt	5.383
4. SUPPORT, Arm to Trans Otr (M29)	5.380	20. NUT, Hex (3/8" x 16)	8.915
5. DAMPER ASM, Prop Shaft (M29)	5.544	21. BOLT, Hex (3/8" x 16 x 2 27/32")	8.900
6. SUPPORT, Arm to Trans Inr (M75)	5.380	22. BOLT, Inr Supt to Trans	5.383
7. SUPPORT, Arm to Trans Otr (M75)	5.380	23. WASHER, Flat (13/32" ID x 13/16" OD)	8.929
8. DAMPER, Prop Shaft (M20-M75)	5.544	24. NUT, Hex (3/8" x 16)	8.915
9. SUPPORT, Arm to Trans Inr (M20)	5.380	25. BOLT, Hex (3/8" x 16 x 3/4")	8.900
10. SUPPORT, Arm to Trans Otr (M20)	5.380	26. BOLT, Hex (3/8" x 16 x 1")	8.900
11. DAMPER, Prop Shaft (M20-M75)	5.544	27. NUT, "U" (3/8" x 16)	8.921
12. ARM, Torque	5.382	28. BOLT, Rr Axle (9/16" x 12 x 6 5/8")	5.383
13. BOLT, Hex (M10 x 1.5 x 20)	8.900	29. WASHER, Flat (19/32" ID x 1 1/8" OD)	8.929
14. NUT, "U" (M8 x 1.25)	8.921	30. NUT, Hex (9/16" x 12)	8.915
15. SCREW, Tap (#10-24 x 3/8")	8.977		
16. BOLT, Hex (M8 x 1.24 x 25)	8.900		

P5-2

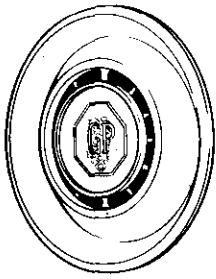

PO1
"G"
5.858 496975 COVER

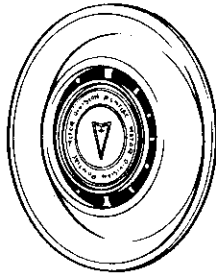

PO1
"A-B-F"
5.858 496972 COVER

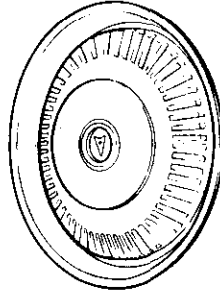

PO1 W/T1
"A-F"
5.858 496931 COVER

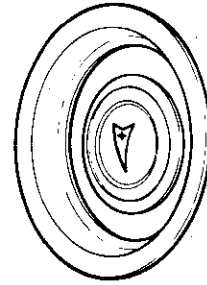

"H"
5.871 3978110 RING ASM
5.858 525747 HUB CAP

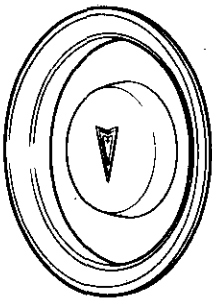

STD.
"F"
5.871 488378 RING ASM
5.858 488953 HUB CAP

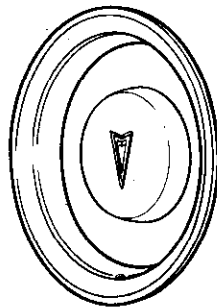

STD.
"A-B-F"
5.871 488380 RING ASM
5.858 488935 HUB CAP

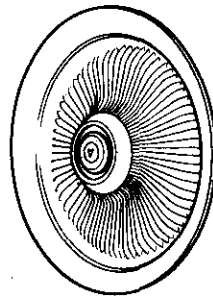

CUSTOM
"X"
5.858 497542 COVER
"A-B-G"
5.858 486554 COVER

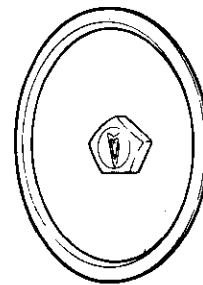

"A-F-G"
5.871 490771 RING ASM
5.871 9795568 ORNAMENT ASM

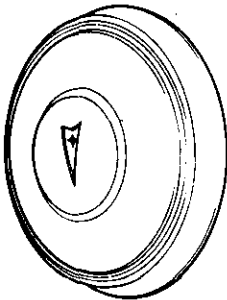

STD.
"A-B-F-X"
5.858 498800 HUB CAP

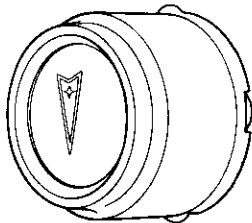

PO5
"H"
5.858 547126 HUB CAP

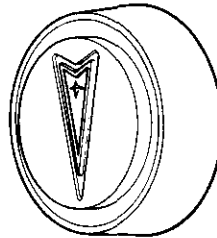

N73, N98
"H"
5.858 499474 HUB CAP

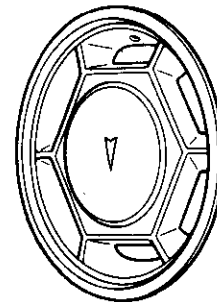

PO2
"H"
5.858 547153 COVER

P5-2

1976 HUB CAPS & WHEEL COVERS

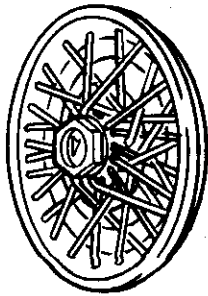

N95
"H" 77-78
5.858 10002254 COVER
"A-B-F-G" 77-78
5.858 549372 COVER

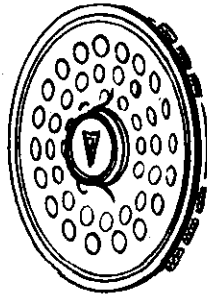

PO1
"A-G" 77
"B-F" 77-78
5.858 527060 COVER

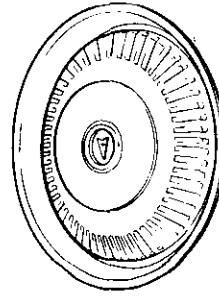

PO1 W/WT1
"A" 77
5.858 496031 COVER
"A-X" 78
5.858 10000413 COVER

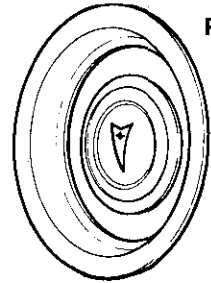

P5-4

N73, N98
"H" 77-78
5.871 465069 RING ASM
5.858 549641 CAP ASM

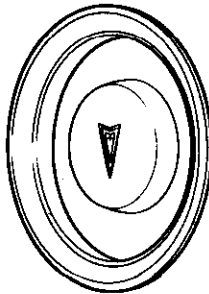

"A-B-F-G" 77
5.871 488380 RING
"X" 77-78
5.871 488378 RING
"A-B-F-G-X" 77-78
5.858 527223 HUB CAP

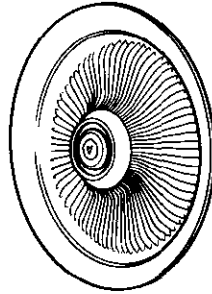

PO2
"X" 77
"A-G-X" 78
5.858 526803 COVER
"A-B-G" 77
"B" 78
5.858 526802 COVER

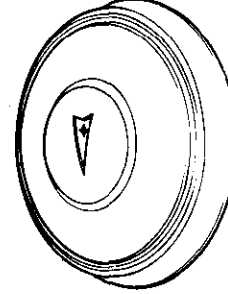

STD.
"A-B-F-X" 77
"A-B-F-G" 78
5.858 498800 HUB CAP

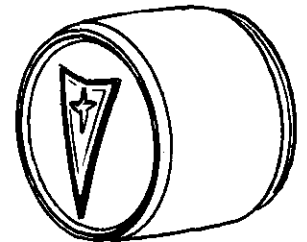

YJ8
"H" 77-78
5.858 546949 HUB CAP

"A-G" 78
5.871 488379 RING
"B-F" 78
5.871 488380 RING

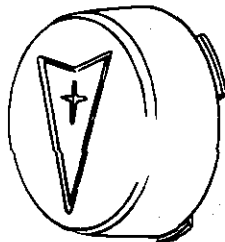

YJ8
"A-B-G" 77-78
5.858 527077 HUB CAP
5.871 527078 ORNAMENT ASM
"F" 77-78
5.858 527086 HUB CAP
5.871 527087 ORNAMENT ASM

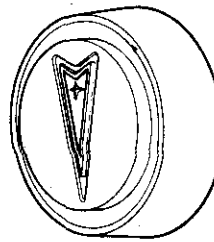

"H" 77-78
5.858 499474 HUB CAP (N73,N98)

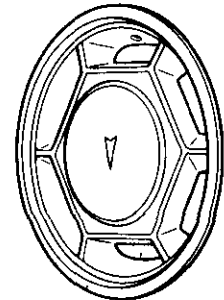

PO2
"H" 77-78
5.858 547153 COVER

P5-4

1977-78 HUB CAPS & WHEEL COVERS

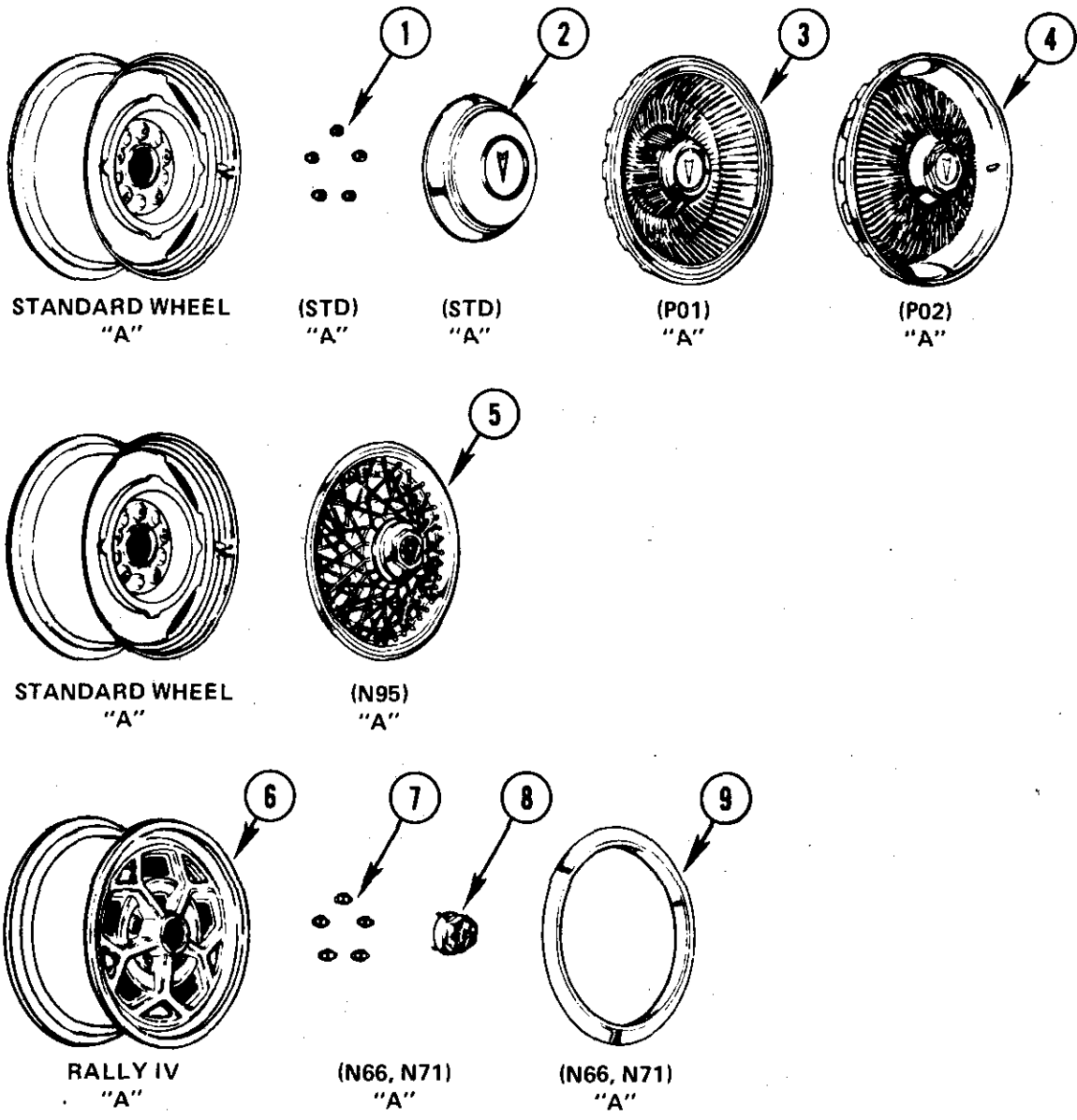

1979 "A" HUB CAPS & WHEEL COVERS

1.	5.813	NUT, Whl (7/16"-20)	358501
2.	5.858	CAP, Whl Hub	498800
3.	5.858	COVER, Whl	10000413
4.	5.858	COVER, Whl	526803
5.	5.858	COVER, Sim Wire Whl	498088
6.	5.803	WHEEL, Rally IV(14" x 6")	10010318
7.	5.813	NUT, Chrome Hex Capped (7/16"-20)	414188
8.	5.858	CAP, Hub	10027285
9.	5.817	RING, Whl Trim	10004649

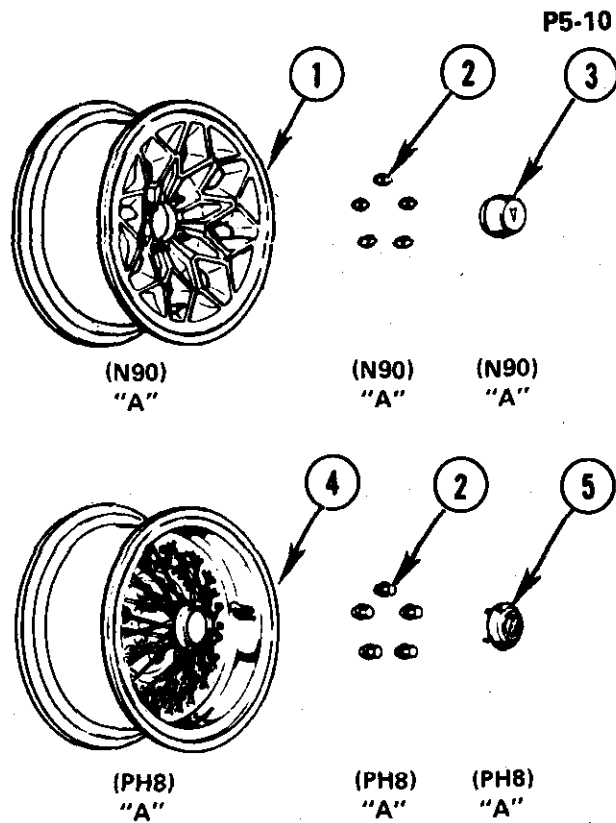

P6-10

1979 "A" HUB CAPS & WHEEL COVERS

1.	5.803	WHEEL, Alum (14" x 6")(Gld)	10008076
2.	5.813	NUT, Chrome Hex Capped (7/16"-20)	371674
3.	5.858	CAP, Whl Hub	527077
4.	5.803	WHEEL, Wire (14" x 6")	10012670
5.	5.858	CAP, Hub	10005580

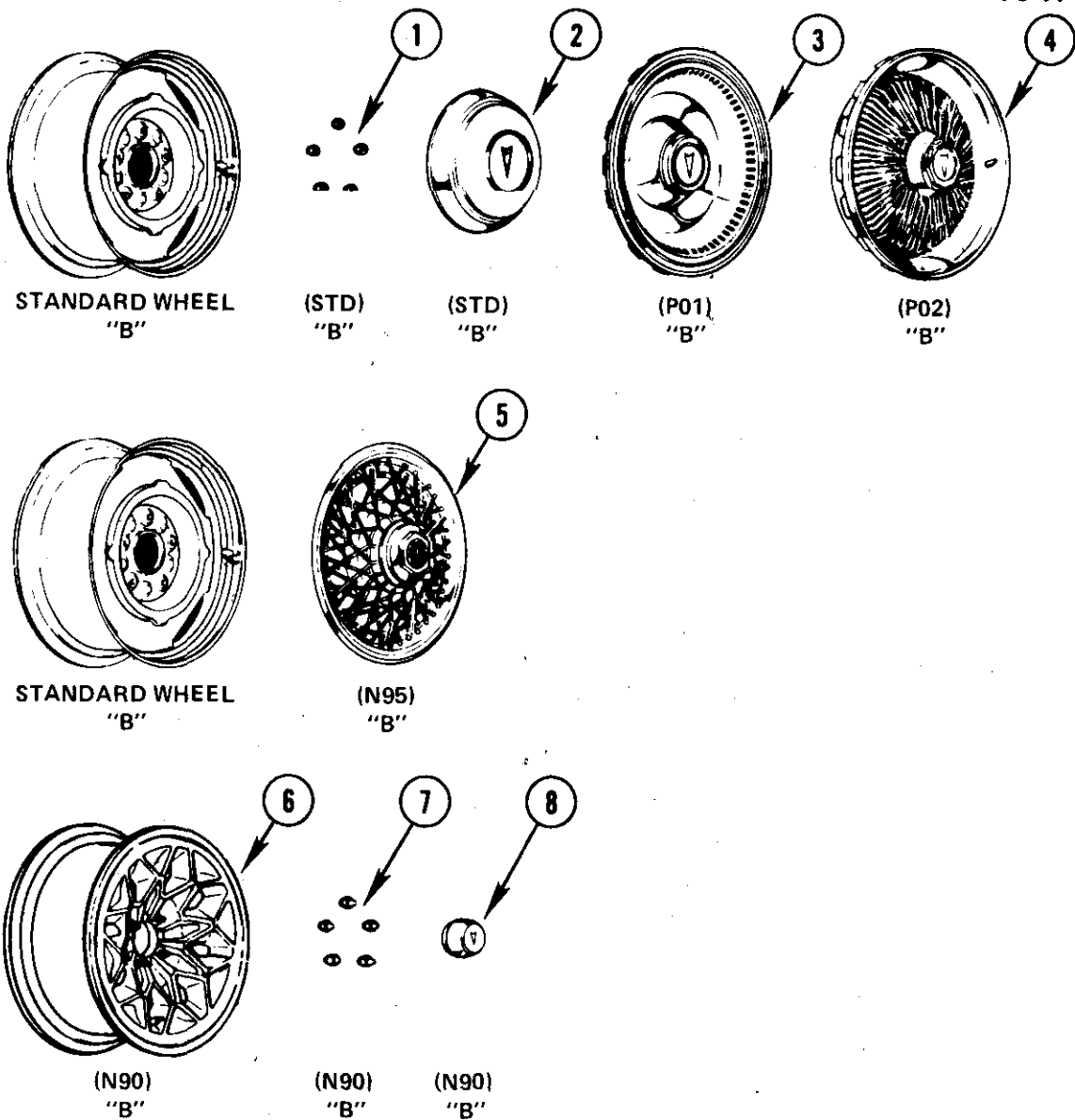

1979 "B" HUB CAPS & WHEEL COVERS

1.	5.813	NUT, Whl (1/2"-20)	516637
2.	5.858	CAP, Whl Hub	498800
3.	5.858	COVER, Whl	10005598
4.	5.858	COVER, Whl	526802
5.	5.858	COVER, Sim Wire Whl	549372
6.	5.803	WHEEL, Alum (15" x 7")(Slv)	10005786
7.	5.813	NUT, Chrome Whl (1/2"-20)	10001566
8.	5.858	CAP, Whl Hub	527077

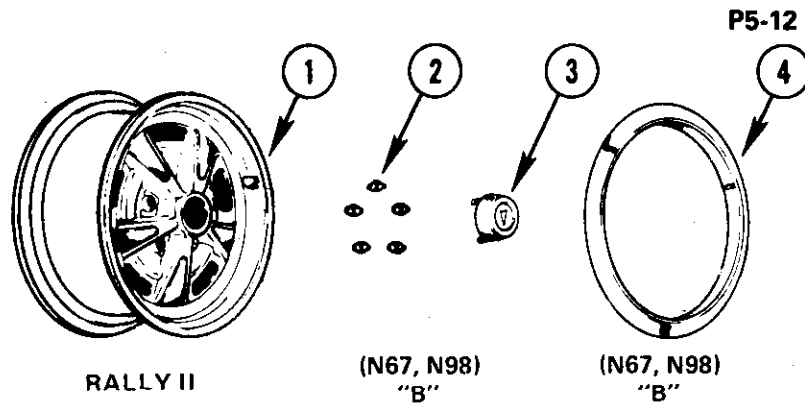

P5-12

1979 "B" HUB CAPS & WHEEL COVERS

1.	5.803	WHEEL (Exc W59)(15" x 6")	10010310
	5.803	WHEEL (W/W59)(15" x 6")	10010312
	5.803	WHEEL (Exc W59)(15" x 7")	10031178
2.	5.813	NUT, Hex Capped(1/2"-20)	414187
3.	5.858	CAP, Hub	527223
	5.871	ORNAMENT, Whl Hub	489148
4.	5.871	RING, Whl Trim	10010686

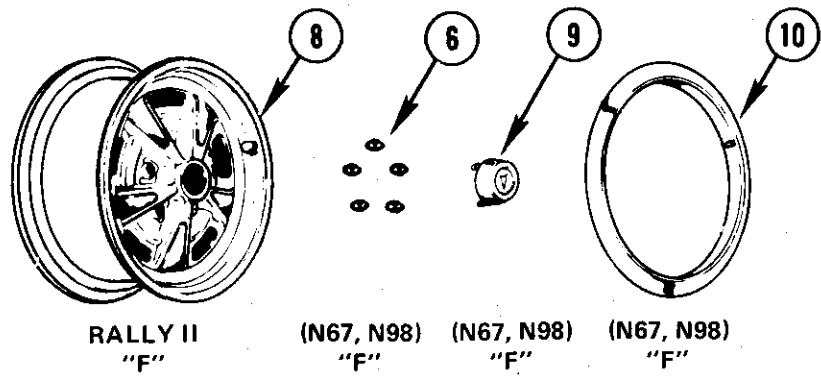
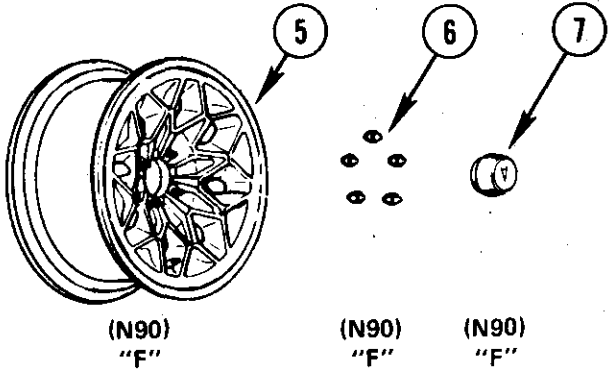
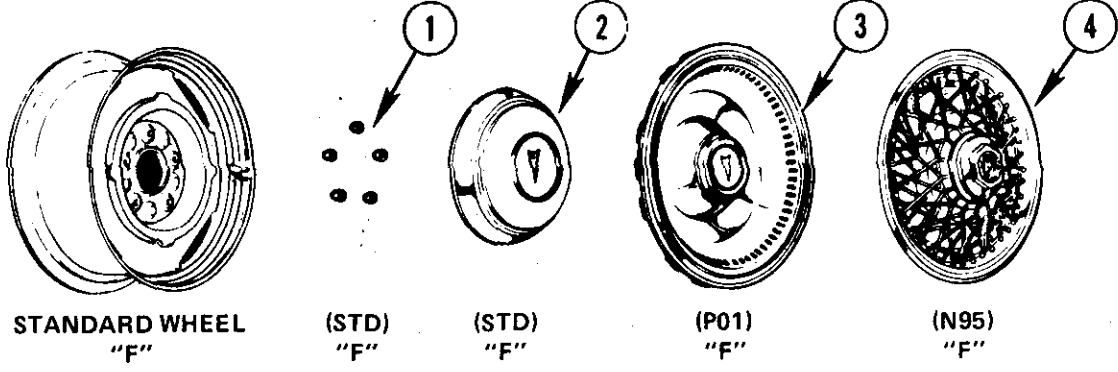

1979 "F" HUB CAPS & WHEEL COVERS

1.	5.813	NUT, Spl Hex (7/16"-20)	358501	5.	5.803	WHEEL, Alum (15" x 7*)(Red)	10010053
2.	5.858	CAP, Whl Hub	498800	6.	5.813	NUT, Capped (7/16"-20)	414188
3.	5.858	COVER, Whl	10005598	7.	5.858	CAP, Hub	527077
	5.871	MEDALLION, Whl Cvr	527062	8.	5.803	WHEEL, Rally (Exc W59) (15" x 6")	10010310
	5.871	RETAINER, Whl Cvr Medallion	1230052	9.	5.858	CAP, Hub	527223
4.	5.858	COVER, Sim Wire Whl	549372		5.871	ORNAMENT, Whl Hub	489148
	5.871	ORNAMENT, Whl Cvr	527078	10.	5.871	RING, Whl Trim	10010686

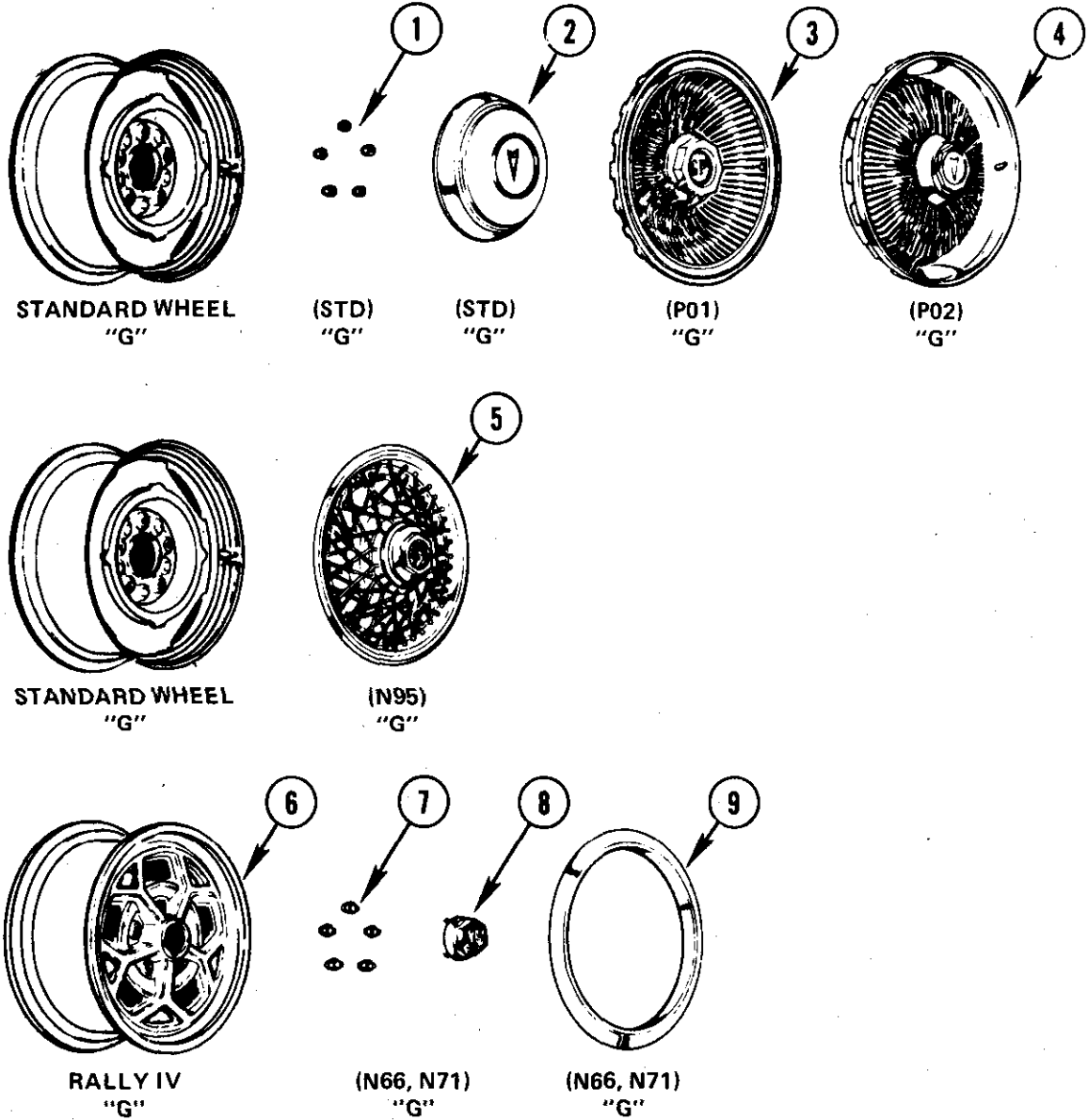

P5-14

1979 "G" HUB CAPS & WHEEL COVERS

1.	5.813	NUT, Whl (7/16"-20)	358501
2.	5.858	CAP, Whl Hub	498800
3.	5.858	COVER, Whl (Non Fin Type)	10001083
4.	5.858	COVER, Whl (Fin Type)	526803
5.	5.858	COVER, Sim Wire Whl	498088
6.	5.803	WHEEL, Rally IV (14" x 6")	10010318
7.	5.813	NUT, Chrome Hex Capped (7/16"-20)	414188
8.	5.858	CAP, Hub	10027285
9.	5.871	RING, Whl Trim	10004649

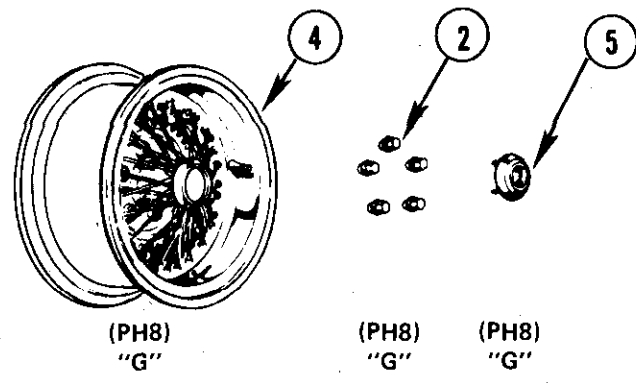
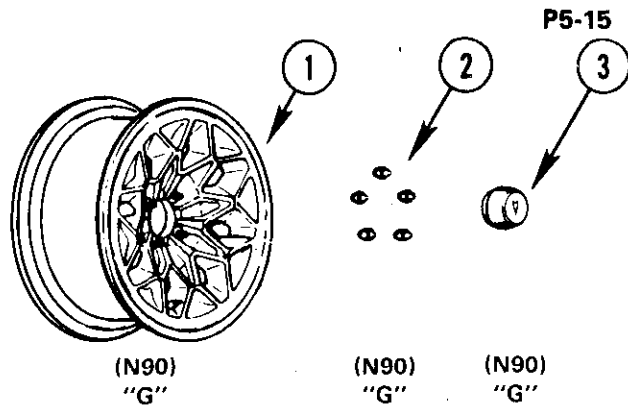

P5-15

1979 "G" HUB CAPS & WHEEL COVERS

1.	5.803	WHEEL, Alum (14" x 6")(Gld)	10008076
2.	5.813	NUT, Chrome Hex Capped (7/16" x 20)	371674
3.	5.858	CAP, Whl Hub	527077
4.	5.803	WHEEL, Wire (14" x 6")	10012670
5.	5.858	CAP, Hub	10005580

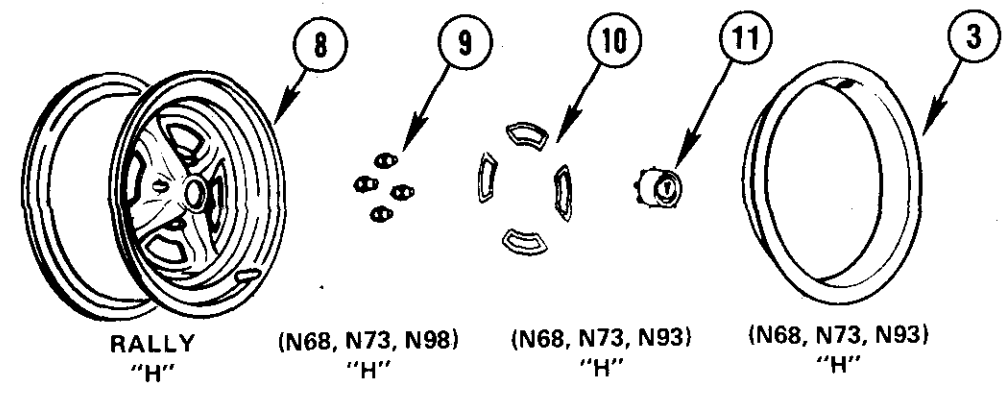
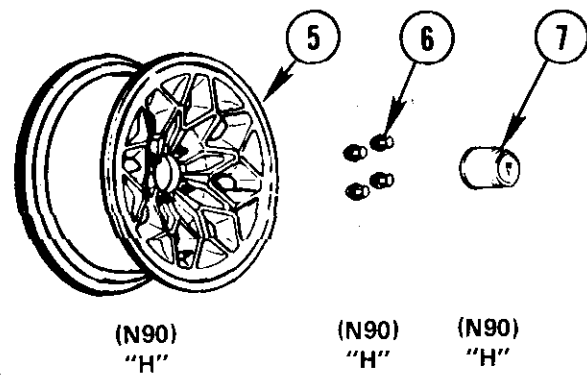
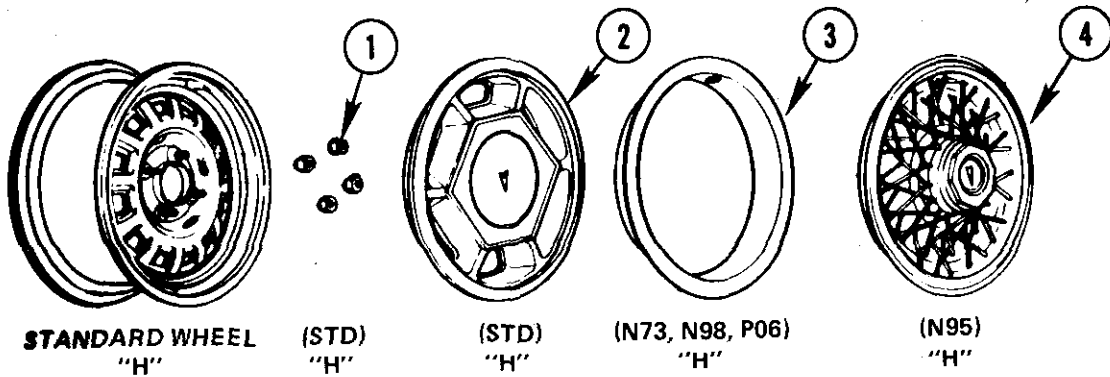

P5-16

1979 "H" HUB CAPS & WHEEL COVERS

1.	5.813	NUT, Wheel (7/16"-20)	358501
2.	5.858	COVER, Wheel Trim	547153
	5.871	ORNAMENT, Wheel ("V")	489146
3.	5.871	RING, Wheel Trim	465069
4.	5.858	COVER, Wheel Trim (Simulated Wire)	10002254
	5.871	ORNAMENT, Wheel Cvr ("V" on Disc)	527078
5.	N.S.	WHEEL, Alum (Gray)(13" x 6")	
6.	5.813	NUT, Wheel Capped (7/16"-20)	371674
7.	5.858	CAP, Hub (W/Alum Whl)	546949
8.	5.803	WHEEL, Rally (13" x 6")	3978191
9.	5.813	NUT, Whl-Chrome Hex Capped (7/16"-20)	414188
10.	5.871	BEZEL, Wheel	551087
11.	5.858	CAP, Hub	499474
	5.871	ORNAMENT, Wheel ("V")	489146

P5-18

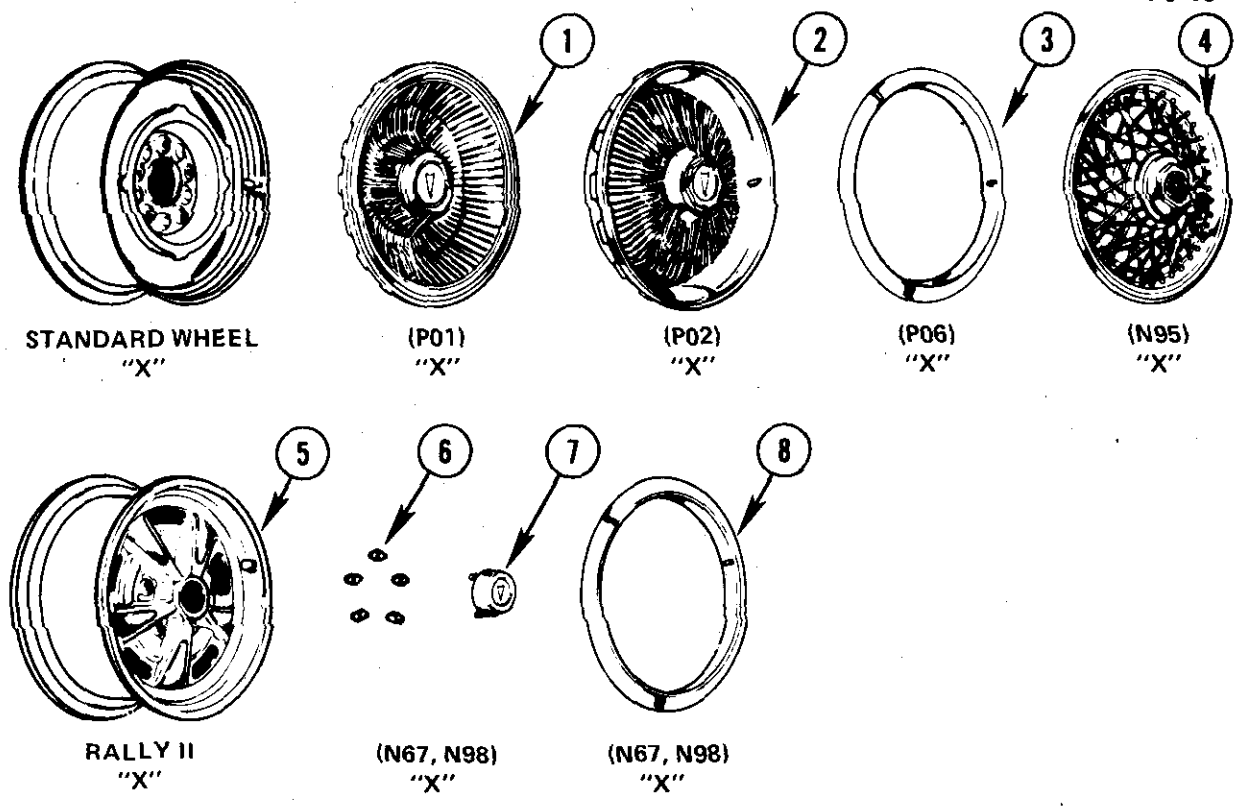

P5-18

1979 "X" HUB CAPS & WHEEL COVERS

1.	5.858	COVER, Whl Trim	10000413
2.	5.858	COVER, Whl Trim	526803
3.	5.871	RING, Whl Trim	14035562
4.	5.858	COVER, Sim Wire Whl	498088
5.	5.803	WHEEL (Exc FE2)(14" x 6")	525708
	N.S.	WHEEL (W/FE2)(14" x 7")	
6.	5.813	NUT, Chrome Hex Capped (7/16"-20)	414188
7.	5.858	CAP, Hub	527223
	5.871	ORNAMENT, Whl Hub	489148
8.	5.871	RING, Whl Trim	488379

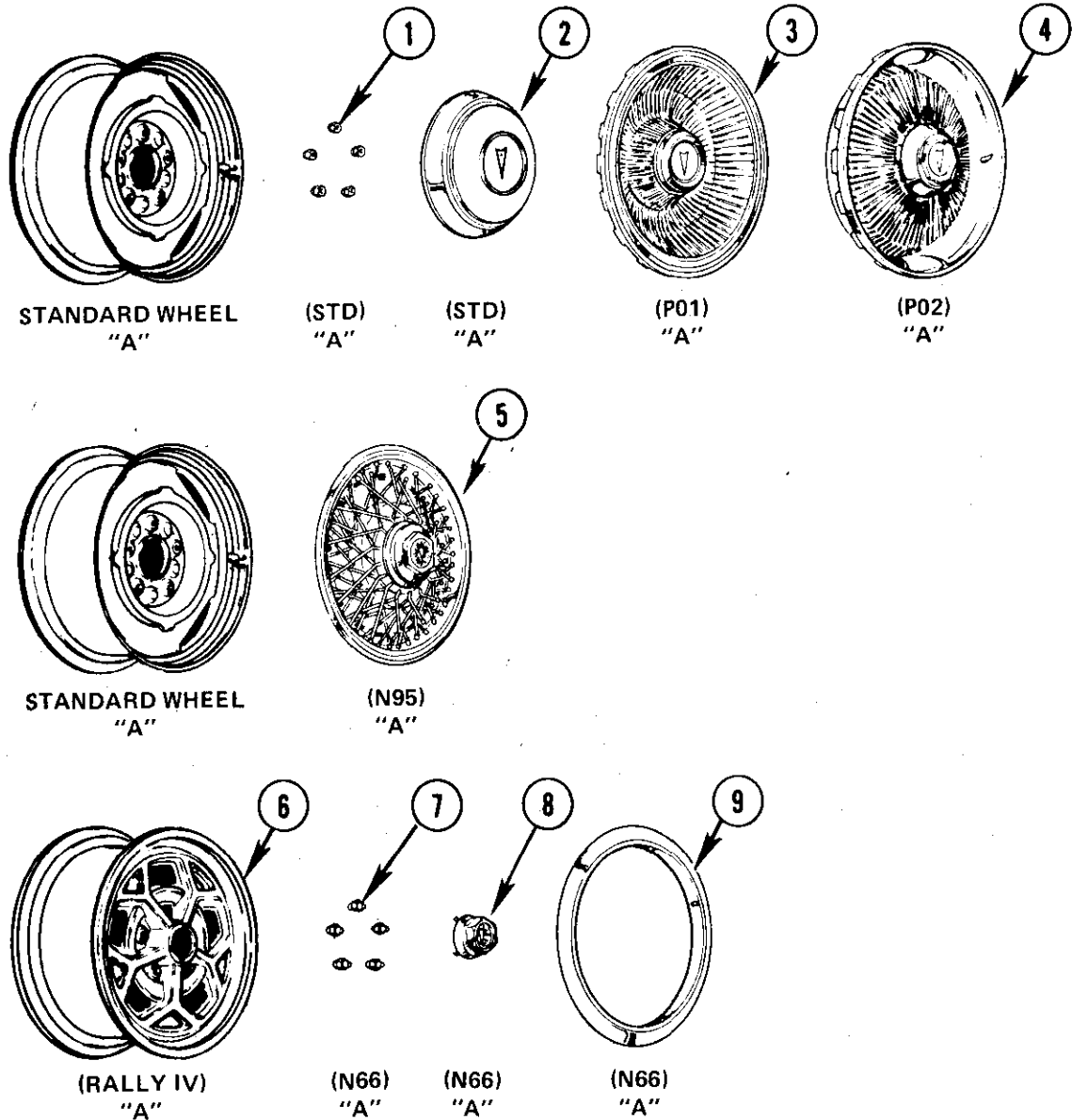

1980-81 "A" HUB CAPS & WHEEL COVERS

1.	5.813	NUT, Spl Hex (7/16"-20)	358501
2.	5.858	CAP, Hub	498800
3.	5.858	COVER, Whl (1980)	10010060
	5.858	COVER, Whl (1981 AD,AF)	10010060
	5.858	COVER, WHL (1981 AJ)	10010062
4.	5.858	COVER, Whl (1980)	10011167
	5.871	ORNAMENT, Whl Cvr	546970
	5.858	COVER, Whl (1981 AD,AF)	10014403
	5.858	COVER, Whl (1981 AJ)	10014404
5.	5.858	COVER, Sim Wire Whl Cvr (1980)(*1)	498088
	5.858	COVER, Sim Wire Whl Cvr(*2)	10013596
	5.871	ORNAMENT, Whl Cvr(*1)	527078
6.	5.803	WHEEL, Rally IV (14" x 6")	10010318
7.	5.813	NUT, Chrome Hex Capped (7/16"-20)	414188
8.	5.858	CAP, Hub	10027285
9.	5.871	RING, Whl Trim	10004649

NOTE 1: First design W/large glue-in type ctr medallion.

NOTE 2: Second design W/small snap in type ctr medallion.

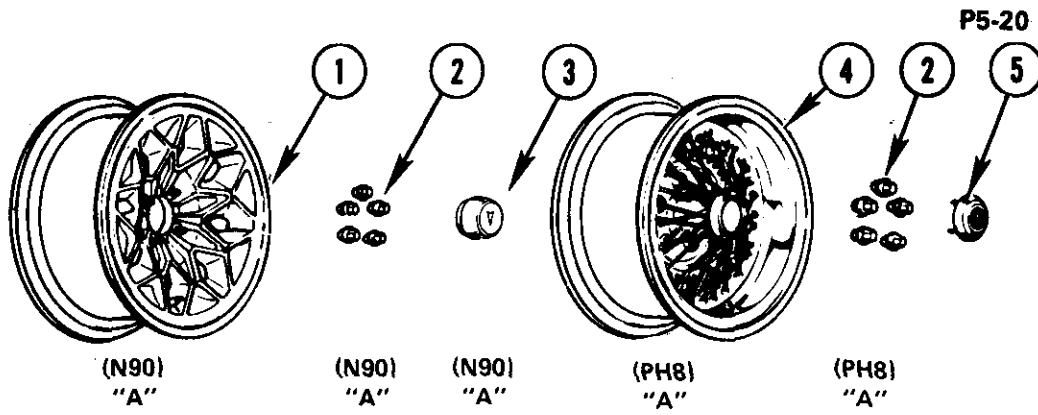

P5-20

1980-81 "A" HUB CAPS & WHEEL COVERS

1.	5.803	WHEEL (Snowflake)(14" x 6")	10008076
2.	5.813	NUT, Cap (7/16"-20)	371674
3.	5.858	CAP, Hub	527077
4.	5.803	WHEEL, Wire (14" x 6")	10012670
5.	5.858	CAP, Hub	10005580

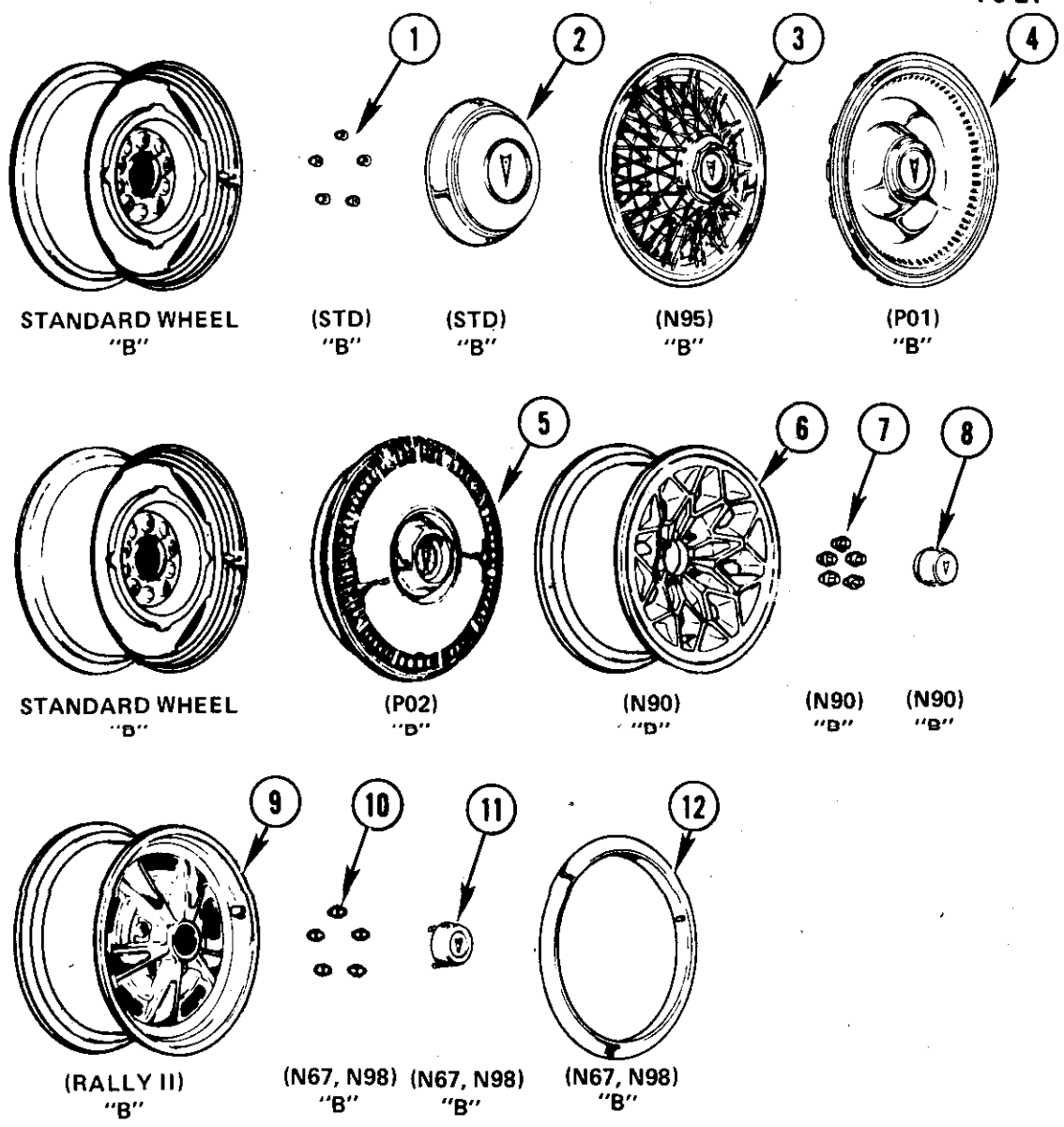

1980-81 "B" HUB CAPS & WHEEL COVERS

1.	5.813	NUT, Whl (1/2"-20)	516637	5.	5.858	COVER, Whl	10010276
2.	5.858	CAP, Hub	498800	6.	5.803	WHEEL, Snowflake (Exc W59)	10013033
3.	5.858	COVER, Sim Wire Whl(*1)	549372		N.S.	WHEEL, Snowflake (W/W59)	
	5.858	COVER, Sim Wire Whl(*2)	10013584	7.	5.813	NUT, Cap (7/16"-20)	371674
	5.871	ORNAMENT, Sim Wire Whl	527078	8.	5.858	CAP, Whl	10010181
	N.S.	LOCK PKG, Cover		9.	5.803	WHEEL, Rally (15" x 7")	10031178
	5.875	BRACKET, Lock	25520262	10.	5.813	NUT, Cap (7/16"-20)	414188
	5.813	NUT, Whl Hub	22506314	11.	5.858	CAP, Hub	527223
	5.813	DECAL, Lock Wire Whl Cvr	10013777	12.	5.871	RING, Whl Trim	10010686
4.	5.858	COVER, Whl	10005598				

NOTE 1: First Design W/Large Glue-in Type Ctr Medallion.
 NOTE 2: Second Design W/Small Snap-in Ctr Medallion.

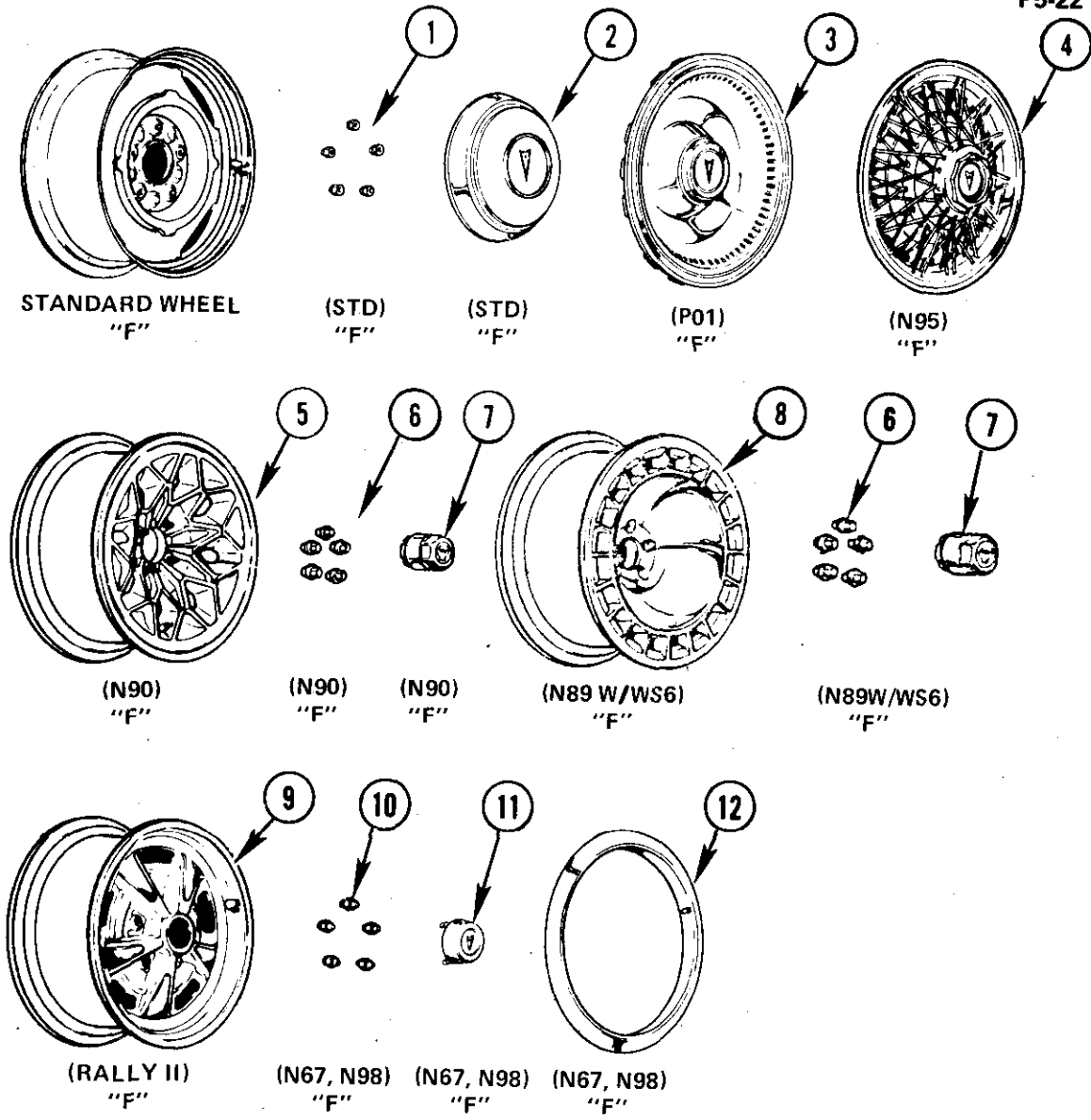

1980-81 "F" HUB CAPS & WHEEL COVERS

1.	5.813	NUT, Spl Hex (7/16"-20)	358501	8.	5.803	WHEEL, Turbo Flow (15" x 8") (Gld)	10013038
2.	5.858	CAP, Hub	498800		5.803	WHEEL, Turbo Flow (15" x 8") (Exc Y85) (Natural Alum)	10007389
3.	5.858	COVER, Whl	10005598		5.803	WHEEL, Turbo Flow (15" x 8") (W/Y85) (Wht)	10012258
4.	5.858	COVER, Sim Wire Whl(*1)	549372	9.	5.803	WHEEL	
	5.858	COVER, Sim Wire Whl(*2)	10013584	10.	5.813	NUT, Cap (7/16"-20)	414188
5.	5.803	WHEEL, Snowflake (15" x 8") (Gld)	10007513	11.	5.858	CAP, Hub	527223
6.	5.813	NUT, Cap (7/16"-20)	371674	12.	5.871	RING, Whl Trim	10010686
7.	5.858	CAP, Hub	10007503				
	5.871	MEDALLION, Hub Cap	10003608				

NOTE 1: First Design W/Large Glue-in Type Ctr Medallion.
 NOTE 2: Second Design W/Small snap-in Type Ctr Medallion.

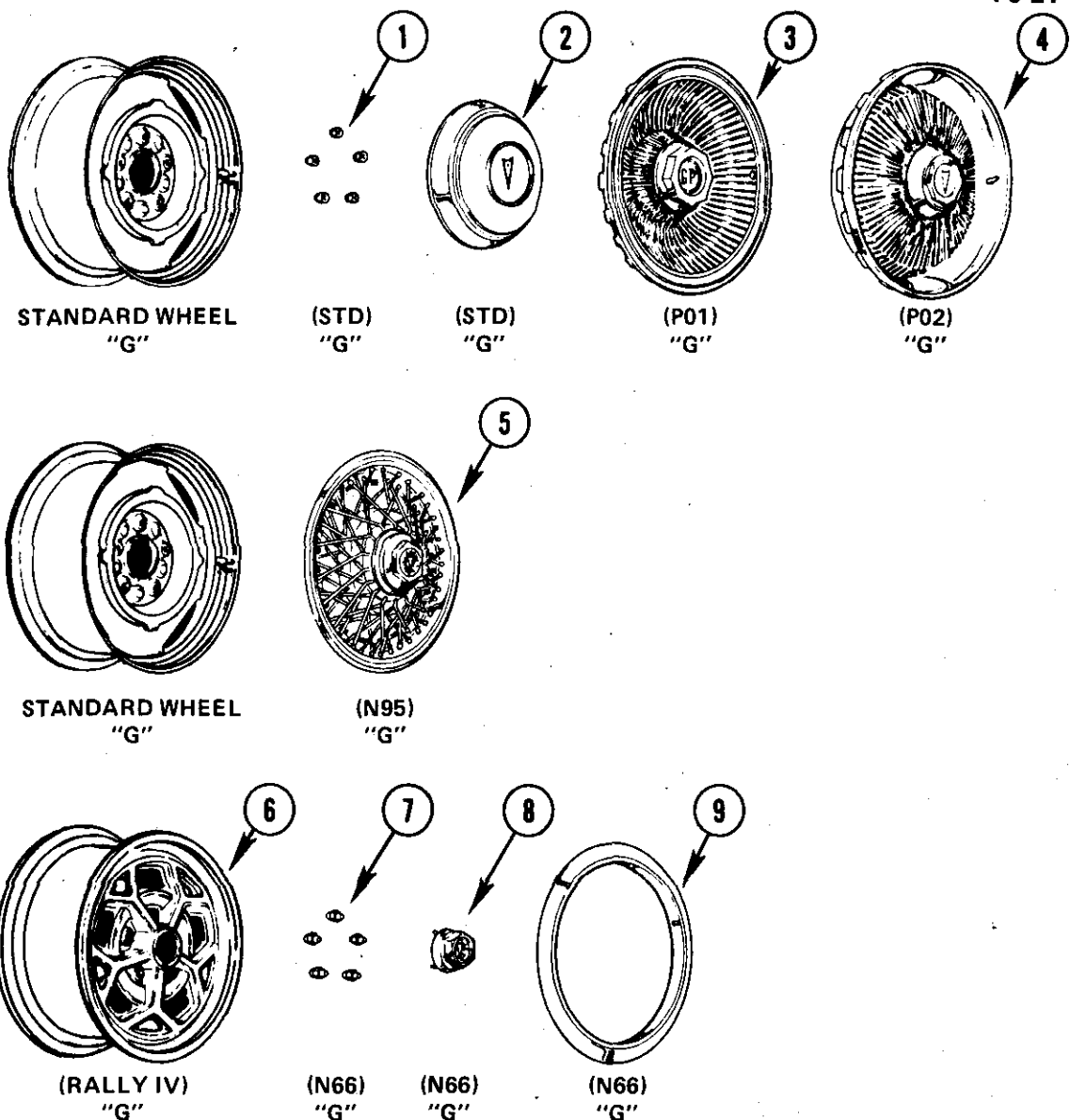

1980 "G" HUB CAPS & WHEEL COVERS

1.	5.813	NUT, Whl (7/16"-20)	358501
2.	5.858	CAP, Whl Hub	498800
3.	5.858	COVER, Whl	10010062
4.	5.858	COVER, Whl	526803
5.	5.858	COVER, Sim Wire Whl(*1)	498088
	5.858	COVER, Sim Wire Whl(*2)	10013596
6.	5.803	WHEEL, Rally IV (14"-6")	10010318
7.	5.813	NUT, Chrome Hex Cap (7/16"-20)	414188
8.	5.858	CAP, Hub	10027285
9.	5.871	RING, Whl Trim	10004649

NOTE 1: First Design w/large glue-in type ctr Medallion.

NOTE 2: Second Design w/small snap-in type ctr Medallion.

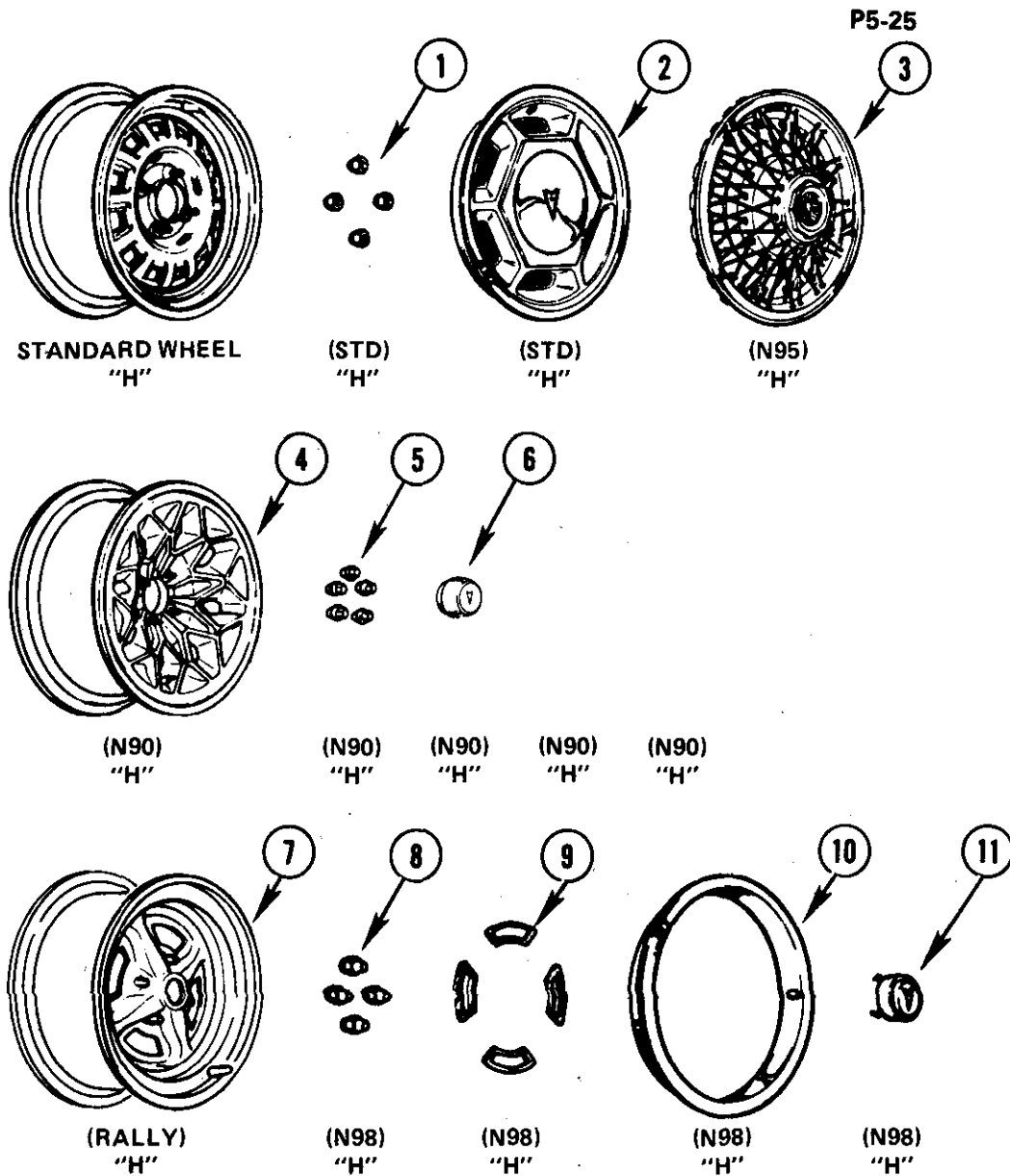

1980-81 "H" HUB CAPS & WHEEL COVERS

1.	5.813	NUT, Whl (7/16"-20)	358501	6.	5.858	CAP, Hub	546949
2.	5.858	COVER, Whl	547153	7.	5.803	WHEEL, Rally (13" x 6") (Paint to Match)	3978191
3.	5.858	COVER, Sim Wire Whl(*1)	10002254	8.	5.813	NUT, Cap (7/16"-20)	414188
	5.858	COVER, Sim Wire Whl(*2)	10013586	9.	5.871	BEZEL, Whl	551087
	5.871	ORNAMENT, Whl Cvr(*3)	527078	10.	5.871	RING, Whl Trim	465069
	5.871	MEDALLION, Whl Cover(*4)	10014237	11.	5.858	CAP, Whl Hub	499474
4.	N.S.	WHEEL, Snowflake (13" x 6")			5.871	ORNAMENT, Whl Hub	489146
5.	5.813	NUT, Cap (7/16"-20)	371674				

NOTE 1: First Design w/large glue-in type ctr Medallion.

NOTE 2: Second Design w/small snap-in type ctr Medallion.

NOTE 3: For Cover w/large glue-in type Medallion.

NOTE 4: For Cover w/small snap-in type Medallion.

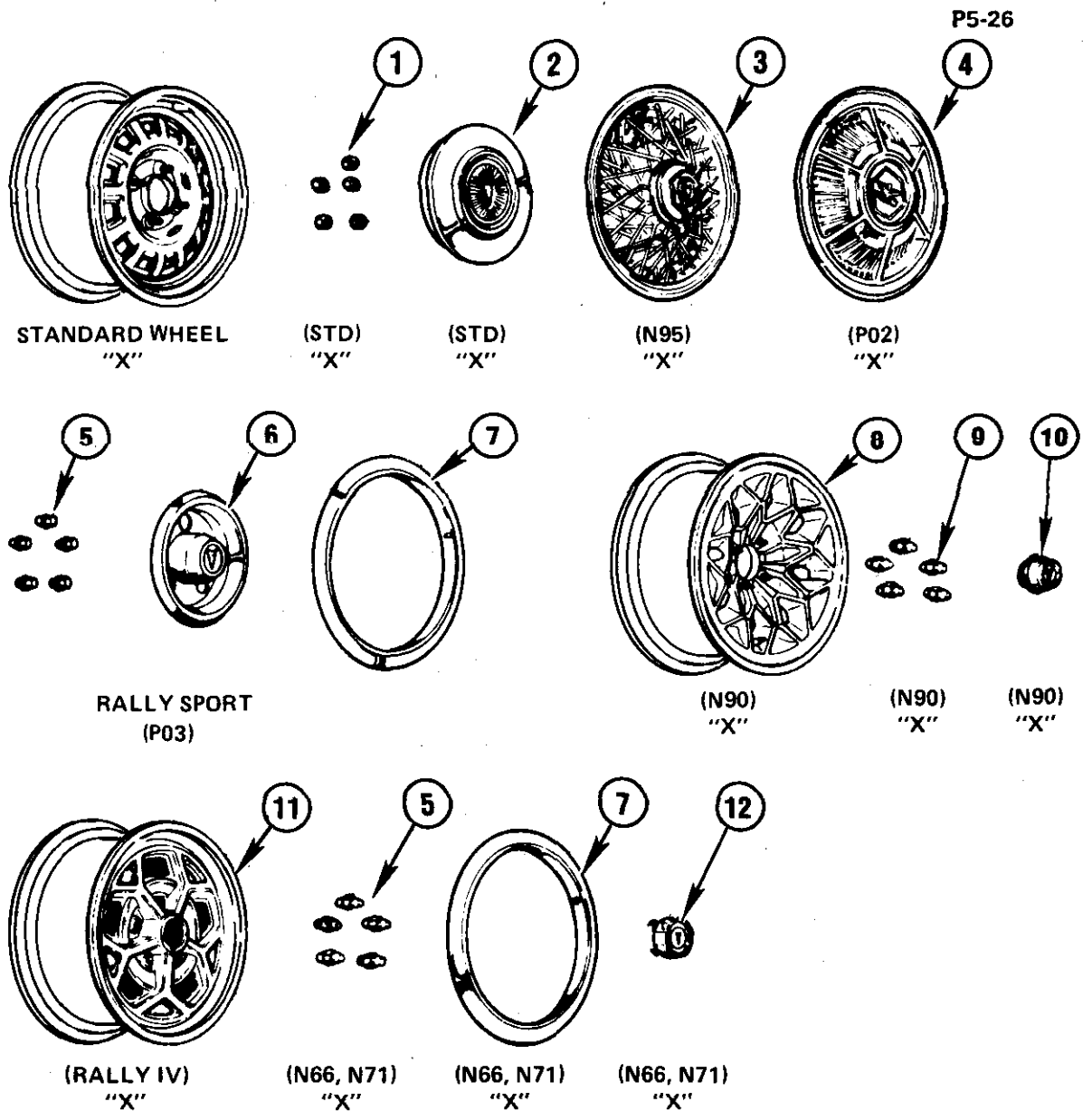

P5-26

1980-81 "X" HUB CAPS & WHEEL COVERS

1.	5.813	NUT, Whl (M12 x 1.5 x 14) ..	9590039	6.	5.858	CAP, Whl Hub	10012049
2.	5.858	CAP, Hub	10006464	7.	5.871	ORNAMENT, Whl Hub Cap	10012050
3.	5.858	COVER, Sim Wire Whl(*1) ..	10005386	8.	5.871	RING, Whl Trim (13")	10007418
	5.858	COVER, Sim Wire Whl(*3) ..	10013598	9.	5.803	WHEEL, Snowflake (13" x 5	
	5.871	ORNAMENT, Whl Cvr(*2) ..	527078			1/2") (Slv)	10006394
	5.871	MEDALLION, Sim Wire Whl		10.	5.813	NUT, Cap	10006262
		(*4)	10014237		5.858	CAP, Hub	10004685
4.	5.858	COVER, Whl (13")	10013677		5.871	MEDALLION, Whl Cap	10004684
	5.871	ORNAMENT, Whl Cvr	10006449	11.	5.803	WHEEL, Styled (13" x 5 1/2")	10022440
5.	5.813	NUT, Cap (M12 x 1.5)	10018202	12.	5.858	CAP, Hub	10005651
					5.871	MEDALLION, Whl Cap	10008033

NOTE 1: First Design w/large glue-in type ctr. Medallion.

NOTE 2: For larger glue-in type Medallion.

NOTE 3: Second Design w/small snap-in type ctr. Medallion.

NOTE 4: For small Snap-in type Medallion.

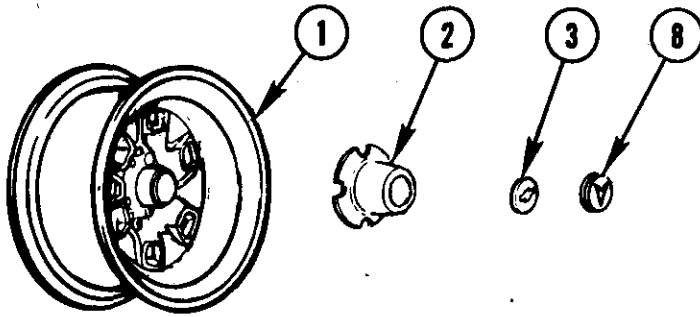

STANDARD WHEEL
"T"

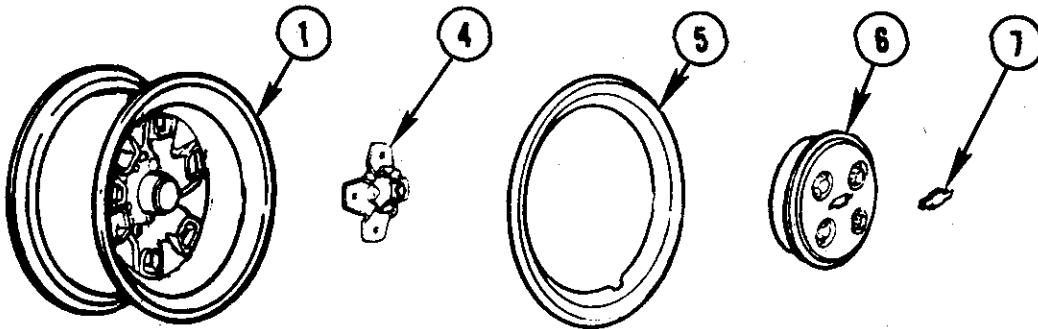

(PO3)
"T"

GM5-12.2

1981 "T" HUB CAPS & WHEEL COVERS

1.	WHEEL (13 x 5)	5.803
2.	CAP, Hub	5.858
3.	INSERT, Hub Cap	5.871
4.	RETAINER, Hub Cap	5.871
5.	RING, Whl Tr	5.871
6.	CAP, Hub	5.858
7.	INSERT, Hub Cap	5.871
8.	INSERT, Hub Cap	5.871